



**Étude des modèles neuronaux profonds pour
la compréhension automatique du langage
naturel dans les habitats intelligents
Annexe**

MISHAKOVA

Anastasiia

Sous la direction de François PORTET et Michel VACHER

Laboratoire : GETALP-LIG

UFR LLASIC

Département Sciences du langage et FLE

Mémoire de master 2 Sciences du Langage orientation Recherche - 30 crédits

Parcours : Industries de la Langues

Année universitaire 2017-2018



DÉCLARATION

1. Ce travail est le fruit d'un travail personnel et constitue un document original.
2. Je sais que prétendre être l'auteur d'un travail écrit par une autre personne est une pratique sévèrement sanctionnée par la loi.
3. Personne d'autre que moi n'a le droit de faire valoir ce travail, en totalité ou en partie, comme le sien.
4. Les propos repris mot à mot à d'autres auteurs figurent entre guillemets (citations).
5. Les écrits sur lesquels je m'appuie dans ce mémoire sont systématiquement référencés selon un système de renvoi bibliographique clair et précis.

NOM : *MISHAKOVA*

PRENOM : *Anastasia*

DATE : *21.06.2018*

SIGNATURE :

Table des matières

A Plan de la maison Amiqua4Home	5
B Occurences dans les corpus	7
B.1 Occurences dans le corpus artificiel	7
B.1.1 Intentions	7
B.1.2 Slot-labels	7
B.1.3 Slot-values	8
B.2 Occurences dans VocADom	9
B.2.1 Intentions	9
B.2.2 Slot-labels	9
B.2.3 Slot-values	10
B.3 Occurences dans SWEET-HOME	11
B.3.1 Intentions	11
B.3.2 Slot-labels	11
B.3.3 Slot-values	11
B.4 Occurences dans PORTMEDIA	12
B.4.1 Intentions	12
B.4.2 Slot-labels	12
B.4.3 Slot-values	13
C Résultats de l'évaluation pour Tf-seq2seq	23
C.1 Appris et testé sur PORTMEDIA : mode mots	23
C.1.1 Intentions	23
C.1.2 Slot-labels	24
C.1.3 Slot-values	26
C.2 Appris sur l'artificiel et testé sur VocADom : mode mots	39
C.2.1 Intentions	39
C.2.2 Slot-labels	40
C.2.3 Slot-values	41
C.3 Appris sur l'artificiel et testé sur VocADom : mode caractères	45
C.3.1 Intentions	45
C.3.2 Slot-labels	46
C.3.3 Slot-values	48
C.4 Appris et testé sur PORTMEDIA sans intention : mode mots	53
C.4.1 Slot-labels	53

C.4.2 Slot-values	55
C.5 Appris et testé sur PORTMEDIA sans intention : mode caractères	64
C.5.1 Slot-labels	64
C.5.2 Slot-values	66
D La distribution des slot-values dans le corpus utilisé par Tf-seq2seq	77

Annexe A

Plan de la maison Amiqua4Home

Les plans de l'appartement sont affichés sur les figures [A.1](#) et [A.2](#). La figure [A.3](#) montre l'intérieur de la cuisine.

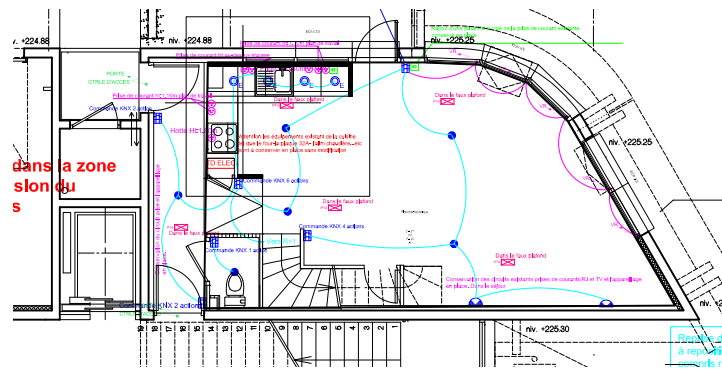

FIGURE A.1 – Rez-de-chaussée de l'appartement Amiqua4Home

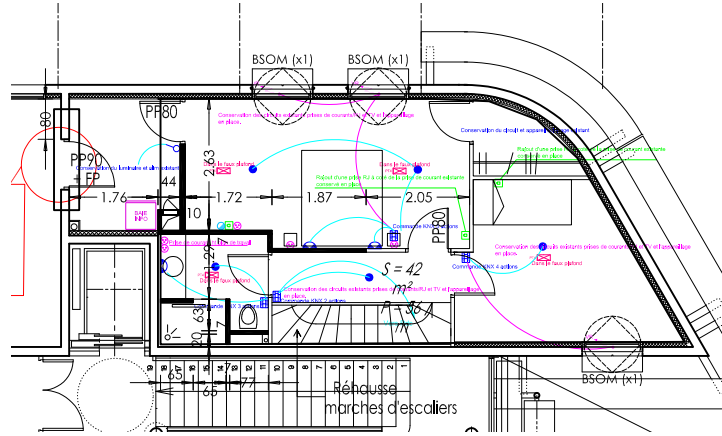

FIGURE A.2 – Premier étage de l'appartement Amiqua4Home



FIGURE A.3 – Vue de la cuisine de l'appartement Amiqua4Home

Annexe B

Les occurrences des intentions, slot-labels et slot-values dans les corpus

B.1 Occurrences dans le corpus artificiel

B.1.1 Intentions

set_device 17375
set_device_group 10475
set_device_property 5250
check_device_group 3982
set_room_property 2640
check_device 1868
contact 595
get_world_property 10

B.1.2 Slot-labels

location-room 40980
device 38950
action 36335
location-floor 27188
location-house 27188
device-setting 5850
device-component 5250
room-property 2640
value-qualitative 2450
value-unit 1440
value-numeric 1440
value-artist 1050
organization 280
person-occupation 280
person-relation 35

world-property 10

B.1.3 Slot-values

true 27188
1 13594
0 13594
light 13050
living_room 10140
turn_up 9070
bedroom 8730
music_player 7800
study 5660
kitchen 5540
bathroom 4820
turn_down 4670
blind 4500
door 4250
volume 4200
close 3900
open 3900
turn_on 3675
turn_off 3675
wc 3490
tv_music_player 3120
temperature 2640
corridor 2600
play_stop 2100
opened 1725
closed 1725
drawer 1700
shutter 1500
degree_celsius 1440
25 1440
a_lot 1225
a_little 1225
lower 1200
raise 1200
off 1195
on 1195
play 1050
change 1050
channel 1050
artistname 1050
cupboard 850

window 850
contact 595
washing_machine 360
hood 360
fan 300
doctor 280
roomba 260
emergency 140
stop 100
fire_brigade 70
supermarket 70
start_up 50
restart 50
kettle 50
pause 50
daughter 35
location 10
weather 5
time 5

B.2 Occurrences dans VocADom

B.2.1 Intentions

set_device 926
set_device_group 515
check_device_group 119
check_device 64
set_room_property 16
set_device_property 6

B.2.2 Slot-labels

device 1653
action 1490
location-room 677
location-floor 529
device-setting 184
location-inroom 22
room-property 17
device-component 5
location-relative 2
location-house 1
value-numeric 1

B.2.3 Slot-values

blind 651
turn_off 372
bedroom 295
1 274
0 255
light 237
close 228
lower 215
open 204
curtain 158
radio 153
turn_on 152
stop 131
kitchen 116
tv_music_player 97
window 90
opened 85
bathroom 84
raise 84
study 81
wc 75
fan 70
kettle 69
shutter 60
closed 60
turn_down 53
door 48
turn_up 48
on 26
living_room 25
heating 18
temperature 17
ceiling 14
off 13
night_table 7
change 3
channel 3
volume 2
stairs 2
shower 2
2 1
right 1
middle 1

house 1

B.3 Occurrences dans SWEET-HOME

B.3.1 Intentions

set_device 425
set_device_group 115
get_world_property 62
check_device_group 45
get_room_property 40
contact 34
check_device 6

B.3.2 Slot-labels

device 593
action 576
world-property 62
device-setting 51
room-property 40
recipient 34
location-room 1

B.3.3 Slot-values

light 305
turn_on 203
turn_off 161
blind 156
time 62
radio 61
lower 60
close 55
opened 51
window 44
temperature 40
open 36
contact 34
raise 27
curtain 18
son 17
daughter 10
door 7

relative_name 4
shutter 2
emergency 1
kitchen 1
granddaughter 1
husband 1

B.4 Occurrences dans PORTMEDIA

B.4.1 Intentions

none 13580
reponse 2604
command-tache 1477
command-dial 365

B.4.2 Slot-labels

reponse 2604
command-tache 1477
objet 1252
temps-date 988
nb-billets 923
nombre 750
nom-piece 609
temps-heure 555
type-billet 526
piece-nom-auteur 462
temps-annee 461
objetBD 369
command-dial 365
lienRef-coRef 193
paiement-montant-entier 161
paiement-monnaie 158
connectAttr 144
connectProp 137
temps-jour-mois 123
lienRef-coDom 120
rang 101
lienRef-elsEns 67
nb-reservation 40
etat-piece-complet 30
numero-reference 15
nom-lieu 14

comparatif-temps 14
type-spectacle 11
temps-unite 11
comparatif-paiement 9
temps-mois 7
temps-jour-semaine 6

B.4.3 Slot-values

oui 1286
reservation 1223
non 1206
2010 456
1 432
singulier 323
TarifReduit 315
2 307
temps-date 266
information 257
piece 211
3 203
addition 203
paiement-montant-entier 202
4 179
pleinTarif 179
0 162
evenement 161
euro 158
confirmation-annonce 156
modification 113
8 112
temps-heure 106
piece-nom-auteur 105
rien 99
5 97
6 97
22h00 96
nb-billets 95
nom-piece 85
18h00 75
7 70
19/07 70
12/07 67
13/07 66
20h00 64

17/07 63
14/07 63
11/07 63
15h00 62
18/07 62
23h00 61
10/07 60
etat-piece-complet 58
22/07 58
23/07 56
pluriel 53
17h00 52
repetition-demande 51
france#culture#en#public 50
premier 48
27 47
24/07 47
16/07 46
08/07 42
11h00 42
15/07 42
25/07 40
16 38
deuxieme 35
20/07 34
piece-resume 34
info-placement 34
type-public 33
annulation 33
09/07 32
entreeLibre 32
numero-reference 31
21/07 30
la#vingt#cinquieme#heure 28
olivier#cadiot 27
explique 27
19h00 27
21 25
jeSaisPas 25
nom-lieu 25
info-salle 25
la#mort#d'#adam 24
rouge 23
26/07 23
info-tarif 22

la#danseuse#malade 21
13 21
julie#andree#t 21
10 19
piece-duree 19
opposition 18
un#nid#pour#quoi#faire 18
flip#book 17
19 17
la#vingt#cinquieme#heure#un#mage#en#ete 17
rodolphe#burger 16
nicolas#truong 16
21h00 16
mathieu#bertholet 16
pasCompris 16
boris#charmatz 16
miroirs#du#reel 16
ludovic#lagarde 15
jean#lambert#wild 15
info-acces-salle 15
cindy#van#acker 15
retrait-billet 15
big#bang 15
type-spectacle 14
confirmation-demande 14
theatre#des#idees 13
implique 13
alain#platel 13
baal 13
restriction 12
pascal#dusapin 12
jean#baptiste#sastre 12
la#tragedie#du#roi#richard#deux 12
20h30 12
23 12
trust 11
micro 11
21h30 11
l'#homme#sans#qualites 11
38 11
not#waterproof 11
delire#a#deux 11
superieur 10
gardenia 10
anna#viebrock 10

l'#orchestre#perdu 10
bal#du#quatorze#juillet 10
troisieme 10
l'#affaire#robinson 10
07/07 10
concert#dessine 10
lanx#obvie 10
info-acces-MobRed 9
obtus#nixe 9
singularites#ordinaires 9
27/07 9
17 9
christophe#feutrier 9
jour 9
papperlapapp 9
inferieur 9
gdra 9
la#vingt#cinquieme#heure#dechiffrage 9
07 9
olivia#grandville 9
alternative 8
catherine#marnas 8
12 8
la#vingt#cinquieme#heure#adieu 8
rencontres#europeennes 8
out#of#context#for#pina 8
gertrude#stein 8
falk#richter 8
joelle#gayot 8
les#corbeaux 8
11 8
faustin#linyekula 8
jonathan#capdevielle 8
14h00 8
massimo#furlan 8
mille#neuf#cent#soixante#treize 8
comment#ai#je#pu#tenir 8
my#secret#garden 8
20 7
pour#en#finir#avec#berenice 7
philippe#menard 7
18 7
la#vingt#cinquieme#heure#dors#toi 7
info-acteur 7
25 7

dernier 7
schutz#vor#der#zukunft 7
chloe#mons 7
08 7
lectures#d'#ecrivains 7
this#is#how#you#will#disappear 7
undetermined 7
frank#van#laecke 7
angelica#liddell 7
car#j'#etais#avec#eux#tout#le#temps 6
la#vingt#cinquieme#heure#cinemoes#live 6
type-placement 6
anouk#van#dijk 6
christoph#marthaler 6
concert 6
christophe#fiat 6
sujets#a#vif#programmation#c#une#semaine#d'#art#en#avignon 6
la#casa#de#la#fuerza 6
jean#rene#lemoine 6
agnes#sourdillon 6
pierre#alferi 6
gisele#vienne 6
el#ano#de#ricardo 5
chouf#ouchouf 5
09 5
15h30 5
pierre#rigal 5
2011 5
antoine#defoort 5
julien#fournet 5
ariane#ascaride 5
22 5
susan#sonntag 5
creation#deux#mille#dix 5
16h30 5
sujets#a#vif#programmation#d#laurent#sauvage#n'#est#pas#une#walkyrie
5
celia#houdart 5
musique 5
24 5
33 5
philippe#quesne 5
frederic#boyer 5
christian#schlittler 5
pierre#michon 5

15 4
18h30 4
josef#nadj 4
martin#zimmermann 4
christophe#huysman 4
guide 4
09h00 4
foofwa#d'#imobilite 4
la#vingt#cinquieme#heure#ethnographiques 4
anne#teresa#de#keersmaeker 4
sebastien#roux 4
12h00 4
sujets#a#vif#programmation#b#black#monde 4
la#vingt#cinquieme#heure#cheval 4
francois#orsoni 4
theatre 3
musee#calvet 3
pierre#baux 3
la#releve#des#dieux#par#les#pitres 3
info-auteur 3
16h00 3
la#vingt#cinquieme#heure#wolfstunde 3
stanislas#nordey 3
samedi 3
piece-etat-complet 3
nombre 3
sujets#a#vif#programmation#a#rosa#seulement 3
la#vingt#cinquieme#heure#ecrits#rock 3
sasha#rau 3
confirmation 3
info-representation 3
sujets#a#vif#programme#d 3
sujets#a#vif 3
26 3
type-billet 3
college#champfleury 2
14 2
dominique#roodthoof 2
attente 2
mois 2
034169 2
der#prozess 2
ecole#d'#art 2
073361 2
sujets#a#vif#programmation#b#parfois#le#corps#n'#a#pas#de#coeur 2

sujets#a#vif#programmation#c#proposition#d'#un#jour#d'#ete 2
sujets#a#vif#programmation#d#au#contraire 2
gymnase#du#lycee#mistrail 2
sujets#a#vif#programmation#a#la#releve#des#dieux#par#les#pitres 2
JeSaisPas 2
mercredi 2
136678 2
022107 2
dimitri#de#perrot 2
thomas#lebrun 2
akosh#szelevenyi 2
temps-unite 2
danse 2
andreas#kriegenburg 2
salle#de#spectacle#de#vedene 2
info-site-web 2
ecoles#au#festival#si#un#chien#rencontre#un#chat 2
ecoles#au#festival#les#helvetes 2
012060 2
vincent#courtois 2
erreur-locuteur 2
silke#mansholt 2
016076 2
guy#cassiers 2
temps-jour-mois 2
138689 2
la#vingt#cinquieme#heure#smatch 2
minimum 2
egal 2
12/01 1
061301 1
025121 1
opera 1
40 1
021101 1
2006 1
116577 1
temps-jour-semaine 1
10h30 1
30/07 1
94100 1
125598 1
086087 1
12345 1
9 1

25/08 1
cour#d' #honneur#du#palais#des#papes 1
035174 1
09h30 1
ecoles#au#festival 1
info-piece 1
094100 1
052056 1
126626 1
27/04 1
035671 1
028136 1
095473 1
repetition 1
proposition#d' #un#jour#d' #ete 1
046230 1
2030 1
02816 1
118589 1
056 1
022110 1
109545 1
118 1
125621 1
054267 1
2000 1
076377 1
553 1
049244 1
094150 1
139692 1
19h30 1
1102506 1
053265 1
063100 1
chapelle#des#penitents#blancs 1
113565 1
13h00 1
099493 1
opera#theatre 1
113562 1
1973 1
1051251 1
sujets#a#vif#programme#a 1
095475 1

112557 1
25/03 1
95473 1
047231 1
062310 1
053263 1
125197 1
mardi 1
100496 1
danseuse#malade 1
quatrieme 1
055275 1
099491 1
110550 1
111554 1
057281 1
108539 1
048200 1
101501 1
04 1
129642 1
103515 1
sujets#a#vif#programmation#c#proposition#d'#un#jour#en#ete 1
30 1
052259 1
092457 1
125196 1
31 1

Annexe C

Résultats de l'évaluation pour Tf-seq2seq

C.1 Appris et testé sur PORTMEDIA : mode mots

C.1.1 Intentions

Métriques non-pondérées

Intent Accuracy				0.9711
Intent Accuracy			per category	
command-tache				0.8848
none				0.9834
command-dial				0.8000
reponse				0.9795
Intent prec/recall/f1				
	precision	recall	f1-score	support
command-dial	0.9412	0.8000	0.8649	40
command-tache	0.9068	0.8848	0.8957	165
none	0.9789	0.9834	0.9812	1509
reponse	0.9695	0.9795	0.9744	292
avg / total	0.9708	0.9711	0.9708	2006

Métriques pondérées

Intent Accuracy				0.9119
Intent Accuracy			per category	
command-tache				0.8848
none				0.9834
command-dial				0.8000
reponse				0.9795
Intent prec/recall/f1				
	precision	recall	f1-score	support
command-dial	0.9983	0.8000	0.8882	28.451158113840865
command-tache	0.9858	0.8848	0.9326	28.45115811384081
none	0.7475	0.9834	0.8494	28.45115811384095
reponse	0.9939	0.9795	0.9866	28.451158113840684
avg / total	0.9314	0.9119	0.9142	113.8046324553633

C.1.2 Slot-labels

Métriques non-pondérées

Slot-label Accuracy	0.6536			
Slot-label Accuracy	per category			
	0.0000			
nom-piece	0.7733			
nombre	0.8000			
connectprop	0.5625			
nom-lieu	0.0000			
paiement-monnaie	0.7500			
type-billet	0.8214			
comparatif-temps	0.0000			
piece-nom-auteur	0.7143			
temps-mois	0.0000			
nb-reservation	0.2500			
etat-piece-complet	0.0000			
type-spectacle	0.0000			
temps-jour-mois	0.7500			
lienref-elsens	0.3750			
command-dial	0.7500			
paiement-montant-entier	0.7500			
comparatif-paiement	0.0000			
nb-billets	0.8762			
objet	0.7239			
reponse	0.9795			
objetbd	0.6098			
temps-heure	0.8657			
temps-unite	0.0000			
connectattr	0.3529			
rang	0.3636			
temps-annee	0.9444			
command-tache	0.8848			
lienref-coref	0.3182			
numero-reference	0.5000			
lienref-codom	0.4667			
temps-jour-semaine	0.0000			
temps-date	0.9292			
Slot-label prec/recall/f1	precision	recall	f1-score	support
	0.0000	0.0000	0.0000	362
command-dial	0.8571	0.7500	0.8000	40
command-tache	0.9068	0.8848	0.8957	165
comparatif-paiement	0.0000	0.0000	0.0000	1
comparatif-temps	0.0000	0.0000	0.0000	2
connectattr	0.1622	0.3529	0.2222	17
connectprop	0.2727	0.5625	0.3673	16
etat-piece-complet	0.0000	0.0000	0.0000	3
lienref-codom	0.2333	0.4667	0.3111	15
lienref-coref	0.2333	0.3182	0.2692	22
lienref-elsens	0.3000	0.3750	0.3333	8
nb-billets	0.8598	0.8762	0.8679	105
nb-reservation	0.2500	0.2500	0.2500	4
nom-lieu	0.0000	0.0000	0.0000	2
nom-piece	0.8286	0.7733	0.8000	75
nombre	0.7912	0.8000	0.7956	90
numero-reference	0.5000	0.5000	0.5000	2
objet	0.6510	0.7239	0.6855	134
objetbd	0.3846	0.6098	0.4717	41
paiement-monnaie	0.7895	0.7500	0.7692	20
paiement-montant-entier	0.7500	0.7500	0.7500	20
piece-nom-auteur	0.6780	0.7143	0.6957	56
rang	0.3077	0.3636	0.3333	11
reponse	0.9695	0.9795	0.9744	292

temps-annee	0.8793	0.9444	0.9107	54
temps-date	0.9459	0.9292	0.9375	113
temps-heure	0.9206	0.8657	0.8923	67
temps-jour-mois	0.4500	0.7500	0.5625	12
temps-jour-semaine	0.0000	0.0000	0.0000	1
temps-mois	0.0000	0.0000	0.0000	1
temps-unite	0.0000	0.0000	0.0000	1
type-billet	0.7667	0.8214	0.7931	56
type-spectacle	0.0000	0.0000	0.0000	2
avg / total	0.6355	0.6536	0.6421	1810

Métriques pondérées

Slot-label Accuracy 0.4882

Slot-label Accuracy per category

	0.0000
nom-piece	0.7733
nombre	0.8000
connectprop	0.5625
nom-lieu	0.0000
paiement-monnaie	0.7500
type-billet	0.8214
comparatif-temps	0.0000
piece-nom-auteur	0.7143
temps-mois	0.0000
nb-reservation	0.2500
etat-piece-complet	0.0000
type-spectacle	0.0000
temps-jour-mois	0.7500
lienref-elsens	0.3750
command-dial	0.7500
paiement-montant-entier	0.7500
comparatif-paiement	0.0000
nb-billets	0.8762
objet	0.7239
reponse	0.9795
objetbd	0.6098
temps-heure	0.8657
temps-unite	0.0000
connectattr	0.3529
rang	0.3636
temps-annee	0.9444
command-tache	0.8848
lienref-coref	0.3182
numero-reference	0.5000
lienref-codom	0.4667
temps-jour-semaine	0.0000
temps-date	0.9292

Slot-label prec/recall/f1

	precision	recall	f1-score	support
	0.0000	0.0000	0.0000	0.13518816702387437
command-dial	0.9819	0.7500	0.8504	0.13518816702387476
command-tache	0.9553	0.8848	0.9187	0.13518816702387465
comparatif-paiement	0.0000	0.0000	0.0000	0.13518816702387473
comparatif-temps	0.0000	0.0000	0.0000	0.13518816702387473
connectattr	0.8047	0.3529	0.4907	0.13518816702387476
connectprop	0.8946	0.5625	0.6907	0.13518816702387476
etat-piece-complet	0.0000	0.0000	0.0000	0.13518816702387476
lienref-codom	0.8802	0.4667	0.6099	0.13518816702387473
lienref-coref	0.8336	0.3182	0.4606	0.13518816702387476
lienref-elsens	0.9510	0.3750	0.5379	0.13518816702387473
nb-billets	0.9548	0.8762	0.9138	0.13518816702387448
nb-reservation	0.9679	0.2500	0.3974	0.13518816702387473
nom-lieu	0.0000	0.0000	0.0000	0.13518816702387473

nom-piece	0.9589	0.7733	0.8562	0.13518816702387462
nombre	0.9384	0.8000	0.8637	0.1351881670238749
numero-reference	0.9945	0.5000	0.6654	0.13518816702387473
objet	0.8344	0.7239	0.7752	0.13518816702387473
objetbd	0.8466	0.6098	0.7089	0.1351881670238748
paiement-monnaie	0.9855	0.7500	0.8518	0.13518816702387473
paiement-montant-entier	0.9819	0.7500	0.8504	0.13518816702387473
piece-nom-auteur	0.9315	0.7143	0.8086	0.13518816702387482
rang	0.9360	0.3636	0.5238	0.1351881670238747
reponse	0.9752	0.9795	0.9773	0.13518816702387465
temps-annee	0.9799	0.9444	0.9619	0.13518816702387476
temps-date	0.9825	0.9292	0.9551	0.13518816702387434
temps-heure	0.9843	0.8657	0.9212	0.13518816702387462
temps-jour-mois	0.9611	0.7500	0.8425	0.1351881670238748
temps-jour-semaine	0.0000	0.0000	0.0000	0.13518816702387473
temps-mois	0.0000	0.0000	0.0000	0.13518816702387473
temps-unite	0.0000	0.0000	0.0000	0.13518816702387473
type-billet	0.9550	0.8214	0.8832	0.13518816702387482
type-spectacle	0.0000	0.0000	0.0000	0.13518816702387473
avg / total	0.6809	0.4882	0.5550	4.461209511787866

C.1.3 Slot-values

Métriques non-pondérées

Slot-value Accuracy	0.5895
Slot-value Accuracy	per category
	0.0000
17/07	1.0000
16	0.3333
confirmation-demande	0.0000
2010	0.9444
temps-date	0.8636
5	0.8333
15/07	1.0000
la#vingt#cinquieme#heure	0.6000
38	0.7500
schutz#vor#der#zukunft	0.0000
faustin#linyekula	0.0000
comment#ai#je#pu#tenir	1.0000
danse	0.0000
tarifreduit	0.6944
jean#baptiste#sastre	0.5000
15h30	0.0000
annulation	0.5000
etat-piece-complet	0.2857
8	0.8462
21	1.0000
samedi	0.0000
info-acces-mobred	0.0000
09	0.0000
singularites#ordinaires	0.0000
confirmation-annonce	0.8571
08/07	0.8750
25/07	1.0000
ariane#ascaride	0.0000
rien	0.8889
16/07	0.6667
type-placement	0.0000
09/07	1.0000
miroirs#du#reel	0.3333
mathieu#bertholet	0.0000
jour	0.0000
olivier#cadiot	1.0000
13	0.0000

3	0.6842
un#nid#pour#quoi#faire	1.0000
31	0.0000
trust	0.0000
type-spectacle	1.0000
sebastien#roux	1.0000
sasha#rau	0.0000
information	0.8276
ecole#d'#art	0.0000
chapelle#des#penitents#blancs	0.0000
18h30	0.0000
reservation	0.8889
17h00	0.8000
12/07	1.0000
23	0.6667
20/07	1.0000
136678	1.0000
sujets#a#vif#programmation#a#rosa#seulement	0.0000
obtus#nixé	1.0000
explique	0.0000
singulier	0.3500
type-billet	0.0000
09h00	0.0000
alternative	0.0000
la#danseuse#malade	0.5000
info-acces-salle	0.0000
10/07	1.0000
13/07	0.5000
sujets#a#vif#programme#a	0.0000
alain#platel	0.0000
frederic#boyer	0.0000
frank#van#laecke	0.0000
la#releve#des#dieux#par#les#pitres	0.0000
33	1.0000
chloe#mons	0.6667
pleintarif	0.6842
piece-etat-complet	0.0000
l'#homme#sans#qualites	0.6667
temps-heure	0.5000
joelle#gayot	0.0000
numero-referance	0.6667
11/07	1.0000
gardenia	0.5000
troisieme	0.0000
susan#sontag	1.0000
type-public	0.4286
19	0.2500
16h00	0.0000
implique	0.0000
112557	0.0000
110550	0.0000
cindy#van#acker	0.0000
boris#charmatz	0.0000
ludovic#lagarde	0.5000
18/07	1.0000
18	1.0000
guy#cassiers	0.0000
superieur	0.0000
20h00	0.8889
22/07	0.7143
gdra	0.0000
piece-resume	0.0000
la#tragedie#du#roi#richard#deux	0.6667
baal	0.5000
21h00	1.0000
repetition-demande	0.6000
nom-lieu	0.0000
12h00	0.0000

anna#viebrock	0.0000	
info-auteur	0.0000	
14h00	0.5000	
sujets#a#vif	1.0000	
la#vingt#cinquieme#heure#adiou	1.0000	
21h30	1.0000	
jesaispas	0.6667	
piece-nom-auteur	0.7500	
entreelibre	0.0000	
11h00	0.5000	
catherine#marnas	0.3333	
046230	0.0000	
lectures#d'#ecrivains	0.0000	
concert#dessine	1.0000	
dernier	1.0000	
061301	0.0000	
info-tarif	0.0000	
piece	0.4828	
pluriel	0.2000	
16h30	0.0000	
sujets#a#vif#programmation#b#black#monde	1.0000	
nicolas#truong	1.0000	
la#vingt#cinquieme#heure#dors#toi	0.0000	
sujets#a#vif#programmation#c#une#semaine#d'#art#en#avignon	0.0000	
4	0.7857	
26/07	0.5714	
evenement	0.4167	
piece-duree	1.0000	
big#bang	1.0000	
nom-piece	0.3333	
paiement-montant-entier	0.6000	
christoph#marthaler	0.0000	
julie#andree#t	0.6667	
19h00	0.5000	
27/07	1.0000	
07/07	0.0000	
23h00	0.8000	
27	1.0000	
info-salle	0.6667	
113562	0.0000	
21/07	1.0000	
france#culture#en#public	1.0000	
19/07	1.0000	
jean#lambert#wild	0.3333	
oui	0.9379	
22h00	1.0000	
theatre#des#idees	1.0000	
agnes#sourdillon	0.5000	
info-acteur	0.0000	
jonathan#capdevielle	1.0000	
047231	0.0000	
car#j'#etais#avec#eux#tout#le#temps	0.0000	
modification	0.6364	
gertrude#stein	1.0000	
la#mort#d'#adam	0.7143	
18h00	0.8750	
6	0.7222	
sujets#a#vif#programmation#a#la#releve#des#dieux#par#les#pitres	1.0000	
opposition	1.0000	
non	1.0000	
premier	0.2000	
la#casa#de#la#fuerza	1.0000	
info-piece	0.0000	
micro	0.0000	
theatre	0.0000	
2	0.8462	
undetermined	0.0000	
restriction	0.0000	

0	0.8333
chouf#ouchouf	0.0000
14/07	1.0000
addition	0.3750
euro	0.7500
celia#houdart	1.0000
l'#orchestre#perdu	1.0000
inferieur	0.0000
23/07	1.0000
nb-billets	0.4286
pascal#dusapin	1.0000
553	0.0000
1	0.6500
15h00	0.8333
ecoles#au#festival	0.0000
25	1.0000
24/07	1.0000
info-placement	0.1667
deuxieme	0.2500
not#waterproof	0.7500
la#vingt#cinquieme#heure#un#mage#en#ete	0.0000
concert	0.0000
07	0.0000
my#secret#garden	0.0000
olivia#grandville	0.0000
philippe#menard	1.0000
24	0.0000
7	0.8571

Slot-value prec/recall/f1

	precision	recall	f1-score	support
	0.0000	0.0000	0.0000	362
0	0.9091	0.8333	0.8696	24
021101	0.0000	0.0000	0.0000	0
046230	0.0000	0.0000	0.0000	1
047231	0.0000	0.0000	0.0000	1
052056	0.0000	0.0000	0.0000	0
061301	0.0000	0.0000	0.0000	1
07	0.0000	0.0000	0.0000	1
07/07	0.0000	0.0000	0.0000	1
073361	0.0000	0.0000	0.0000	0
08/07	0.7778	0.8750	0.8235	8
09	0.0000	0.0000	0.0000	1
09/07	0.6667	1.0000	0.8000	2
09h00	0.0000	0.0000	0.0000	1
1	0.5532	0.6500	0.5977	40
10	0.0000	0.0000	0.0000	0
10/07	1.0000	1.0000	1.0000	10
11/07	1.0000	1.0000	1.0000	3
110550	0.0000	0.0000	0.0000	1
111554	0.0000	0.0000	0.0000	0
112557	0.0000	0.0000	0.0000	1
113562	0.0000	0.0000	0.0000	1
11h00	1.0000	0.5000	0.6667	4
12/07	1.0000	1.0000	1.0000	4
125196	0.0000	0.0000	0.0000	0
12h00	0.0000	0.0000	0.0000	1
13	0.0000	0.0000	0.0000	1
13/07	1.0000	0.5000	0.6667	4
136678	1.0000	1.0000	1.0000	1
14/07	1.0000	1.0000	1.0000	10
14h00	1.0000	0.5000	0.6667	2
15/07	1.0000	1.0000	1.0000	3
15h00	0.7143	0.8333	0.7692	6
15h30	0.0000	0.0000	0.0000	1
16	1.0000	0.3333	0.5000	6
16/07	1.0000	0.6667	0.8000	3

ANNEXE C. RÉSULTATS DE L'ÉVALUATION POUR TF-SEQ2SEQ

16h00	0.0000	0.0000	0.0000	1
16h30	0.0000	0.0000	0.0000	2
17	0.0000	0.0000	0.0000	0
17/07	1.0000	1.0000	1.0000	9
17h00	0.8000	0.8000	0.8000	5
18	1.0000	1.0000	1.0000	1
18/07	1.0000	1.0000	1.0000	4
18h00	0.7000	0.8750	0.7778	8
18h30	0.0000	0.0000	0.0000	1
19	0.2500	0.2500	0.2500	4
19/07	0.8182	1.0000	0.9000	9
19h00	0.5000	0.5000	0.5000	2
2	0.9167	0.8462	0.8800	39
20/07	0.8333	1.0000	0.9091	5
2010	0.8793	0.9444	0.9107	54
20h00	0.8889	0.8889	0.8889	9
20h30	0.0000	0.0000	0.0000	0
21	0.1667	1.0000	0.2857	1
21/07	0.6667	1.0000	0.8000	2
21h00	1.0000	1.0000	1.0000	1
21h30	1.0000	1.0000	1.0000	1
22/07	1.0000	0.7143	0.8333	7
22h00	0.9231	1.0000	0.9600	12
23	0.5000	0.6667	0.5714	3
23/07	1.0000	1.0000	1.0000	5
23h00	0.8000	0.8000	0.8000	10
24	0.0000	0.0000	0.0000	1
24/07	1.0000	1.0000	1.0000	12
25	1.0000	1.0000	1.0000	2
25/07	1.0000	1.0000	1.0000	4
26/07	1.0000	0.5714	0.7273	7
27	0.8333	1.0000	0.9091	5
27/07	1.0000	1.0000	1.0000	1
3	0.6190	0.6842	0.6500	19
31	0.0000	0.0000	0.0000	1
33	1.0000	1.0000	1.0000	1
38	0.7500	0.7500	0.7500	4
4	0.7586	0.7857	0.7719	28
5	1.0000	0.8333	0.9091	6
553	0.0000	0.0000	0.0000	1
6	0.7222	0.7222	0.7222	18
7	0.8571	0.8571	0.8571	7
8	0.8462	0.8462	0.8462	13
addition	0.1552	0.3750	0.2195	24
agnes#sourdillon	1.0000	0.5000	0.6667	2
alain#platel	0.0000	0.0000	0.0000	1
alternative	0.0000	0.0000	0.0000	1
anna#viebrock	0.0000	0.0000	0.0000	3
annulation	0.5000	0.5000	0.5000	2
ariane#ascaride	0.0000	0.0000	0.0000	1
attente	0.0000	0.0000	0.0000	0
baal	1.0000	0.5000	0.6667	2
bal#du#quatorze#juillet	0.0000	0.0000	0.0000	0
big#bang	1.0000	1.0000	1.0000	2
boris#charmatz	0.0000	0.0000	0.0000	1
car#j'#etais#avec#eux#tout#le#temps	0.0000	0.0000	0.0000	1
catherine#marnas	0.3333	0.3333	0.3333	3
celia#houdart	1.0000	1.0000	1.0000	1
chapelle#des#penitents#blancs	0.0000	0.0000	0.0000	1
chloe#mons	1.0000	0.6667	0.8000	3
chouf#ouchouf	0.0000	0.0000	0.0000	1
christoph#marthaler	0.0000	0.0000	0.0000	1
christophe#fiat	0.0000	0.0000	0.0000	0
christophe#huysman	0.0000	0.0000	0.0000	0
cindy#van#acker	0.0000	0.0000	0.0000	1
comment#ai#je#pu#tenir	1.0000	1.0000	1.0000	1
concert	0.0000	0.0000	0.0000	1
concert#dessine	1.0000	1.0000	1.0000	1

confirmation-annonce	0.8571	0.8571	0.8571	21
confirmation-demande	0.0000	0.0000	0.0000	2
danse	0.0000	0.0000	0.0000	1
dernier	1.0000	1.0000	1.0000	1
deuxieme	0.5000	0.2500	0.3333	4
ecole#d'#art	0.0000	0.0000	0.0000	1
ecoles#au#festival	0.0000	0.0000	0.0000	1
entreelibre	0.0000	0.0000	0.0000	1
etat-piece-complet	0.1818	0.2857	0.2222	7
euro	0.7895	0.7500	0.7692	20
evenement	0.1923	0.4167	0.2632	12
explique	0.0000	0.0000	0.0000	2
falk#richter	0.0000	0.0000	0.0000	0
faustin#linyekula	0.0000	0.0000	0.0000	1
france#culture#en#public	0.8000	1.0000	0.8889	8
frank#van#laecke	0.0000	0.0000	0.0000	1
frederic#boyer	0.0000	0.0000	0.0000	1
gardenia	0.5000	0.5000	0.5000	2
gdra	0.0000	0.0000	0.0000	1
gertrude#stein	0.6667	1.0000	0.8000	2
gisele#vienne	0.0000	0.0000	0.0000	0
guy#cassiers	0.0000	0.0000	0.0000	1
implique	0.0000	0.0000	0.0000	2
inferieur	0.0000	0.0000	0.0000	1
info-acces-mobred	0.0000	0.0000	0.0000	1
info-acces-salle	0.0000	0.0000	0.0000	2
info-acteur	0.0000	0.0000	0.0000	1
info-auteur	0.0000	0.0000	0.0000	1
info-piece	0.0000	0.0000	0.0000	1
info-placement	0.5000	0.1667	0.2500	6
info-salle	0.4000	0.6667	0.5000	3
info-site-web	0.0000	0.0000	0.0000	0
info-tarif	0.0000	0.0000	0.0000	3
information	0.8889	0.8276	0.8571	29
jean#baptiste#sastre	0.5000	0.5000	0.5000	2
jean#lambert#wild	0.6667	0.3333	0.4444	6
jesaispas	1.0000	0.6667	0.8000	3
joelle#gayot	0.0000	0.0000	0.0000	1
jonathan#capdevielle	1.0000	1.0000	1.0000	1
jour	0.0000	0.0000	0.0000	1
julie#andree#t	0.6667	0.6667	0.6667	3
julien#fournet	0.0000	0.0000	0.0000	0
l'#homme#sans#qualites	1.0000	0.6667	0.8000	3
l'#orchestre#perdu	1.0000	1.0000	1.0000	2
la#casa#de#la#fuerza	1.0000	1.0000	1.0000	1
la#danseuse#malade	0.5000	0.5000	0.5000	2
la#mort#d'#adam	0.8333	0.7143	0.7692	7
la#releve#des#dieux#par#les#pitres	0.0000	0.0000	0.0000	1
la#tragedie#du#roi#richard#deux	0.6667	0.6667	0.6667	3
la#vingt#cinquieme#heure	0.7500	0.6000	0.6667	5
la#vingt#cinquieme#heure#adieu	0.2000	1.0000	0.3333	1
la#vingt#cinquieme#heure#cheval	0.0000	0.0000	0.0000	0
la#vingt#cinquieme#heure#dechifffrage	0.0000	0.0000	0.0000	0
la#vingt#cinquieme#heure#dors#toi	0.0000	0.0000	0.0000	1
la#vingt#cinquieme#heure#un#mage#en#ete	0.0000	0.0000	0.0000	1
lectures#d'#ecrivains	0.0000	0.0000	0.0000	1
ludovic#lagarde	0.2000	0.5000	0.2857	2
mathieu#bertholet	0.0000	0.0000	0.0000	4
micro	0.0000	0.0000	0.0000	1
miroirs#du#reel	1.0000	0.3333	0.5000	3
modification	0.8750	0.6364	0.7368	11
musique	0.0000	0.0000	0.0000	0
my#secret#garden	0.0000	0.0000	0.0000	2
nb-billets	0.2000	0.4286	0.2727	7
nicolas#truong	1.0000	1.0000	1.0000	2
nom-lieu	0.0000	0.0000	0.0000	1
nom-piece	0.3750	0.3333	0.3529	9
nombre	0.0000	0.0000	0.0000	0

non	0.9718	1.0000	0.9857	138
not#waterproof	1.0000	0.7500	0.8571	4
numero-reference	0.6667	0.6667	0.6667	3
obtus#nixe	1.0000	1.0000	1.0000	1
olivia#grandville	0.0000	0.0000	0.0000	1
olivier#cadiot	1.0000	1.0000	1.0000	4
opposition	0.1667	1.0000	0.2857	1
oui	0.9444	0.9379	0.9412	145
paiement-montant-entier	0.7200	0.6000	0.6545	30
pascal#dusapin	1.0000	1.0000	1.0000	1
philippe#menard	1.0000	1.0000	1.0000	2
piece	0.3590	0.4828	0.4118	29
piece-duree	0.2500	1.0000	0.4000	1
piece-etat-complet	0.0000	0.0000	0.0000	1
piece-nom-auteur	0.6000	0.7500	0.6667	12
piece-resume	0.0000	0.0000	0.0000	5
pierre#alferi	0.0000	0.0000	0.0000	0
pierre#baux	0.0000	0.0000	0.0000	0
pleintarif	0.7647	0.6842	0.7222	19
pluriel	0.1429	0.2000	0.1667	5
premier	0.3333	0.2000	0.2500	5
repetition-demande	0.7500	0.6000	0.6667	5
reservation	0.9023	0.8889	0.8955	135
restriction	0.0000	0.0000	0.0000	3
retrait-billet	0.0000	0.0000	0.0000	0
rien	1.0000	0.8889	0.9412	9
rodolphe#burger	0.0000	0.0000	0.0000	0
samedi	0.0000	0.0000	0.0000	1
sasha#rau	0.0000	0.0000	0.0000	1
schutz#vor#der#zukunft	0.0000	0.0000	0.0000	1
sebastien#roux	1.0000	1.0000	1.0000	1
singularites#ordinaires	0.0000	0.0000	0.0000	1
singulier	0.2222	0.3500	0.2718	40
stanislas#nordey	0.0000	0.0000	0.0000	0
sujets#a#vif	1.0000	1.0000	1.0000	1
sujets#a#vif#programmation#a#la#releve#des#dieux#par#les#pitres	1.0000	1.0000	1.0000	1
sujets#a#vif#programmation#a#rosa#seulement	0.0000	0.0000	0.0000	1
sujets#a#vif#programmation#b#black#monde	0.6667	1.0000	0.8000	2
sujets#a#vif#programmation#c#une#semaine#d'#art#en#avignon	0.0000	0.0000	0.0000	1
sujets#a#vif#programmation#d#au#contraire	0.0000	0.0000	0.0000	0
sujets#a#vif#programme#a	0.0000	0.0000	0.0000	1
superieur	0.0000	0.0000	0.0000	2
susan#sontag	1.0000	1.0000	1.0000	1
tarifreduit	0.6098	0.6944	0.6494	36
temps-date	0.7308	0.8636	0.7917	22
temps-heure	0.2000	0.5000	0.2857	6
theatre	0.0000	0.0000	0.0000	1
theatre#des#idees	0.3333	1.0000	0.5000	1
troisieme	0.0000	0.0000	0.0000	1
trust	0.0000	0.0000	0.0000	2
type-billet	0.0000	0.0000	0.0000	1
type-placement	0.0000	0.0000	0.0000	1
type-public	0.7500	0.4286	0.5455	7
type-spectacle	0.6667	1.0000	0.8000	2
un#nid#pour#quoi#faire	0.6667	1.0000	0.8000	4
undetermined	0.0000	0.0000	0.0000	1
vincent#courtois	0.0000	0.0000	0.0000	0
avg / total	0.5851	0.5895	0.5806	1810

Métriques pondérées

Slot-value Accuracy	0.4735
Slot-value Accuracy	per category
	0.0000
17/07	1.0000
16	0.3333

confirmation-demande	0.0000
2010	0.9444
temps-date	0.8636
5	0.8333
15/07	1.0000
la#vingt#cinquieme#heure	0.6000
38	0.7500
schutz#vor#der#zukunft	0.0000
faustin#linyekula	0.0000
comment#ai#je#pu#tenir	1.0000
danse	0.0000
tarifreduit	0.6944
jean#baptiste#sastre	0.5000
15h30	0.0000
annulation	0.5000
etat-piece-complet	0.2857
8	0.8462
21	1.0000
samedi	0.0000
info-acces-mobred	0.0000
09	0.0000
singularites#ordinaires	0.0000
confirmation-annonce	0.8571
08/07	0.8750
25/07	1.0000
ariane#ascaride	0.0000
rien	0.8889
16/07	0.6667
type-placement	0.0000
09/07	1.0000
miroirs#du#reel	0.3333
mathieu#bertholet	0.0000
jour	0.0000
olivier#cadiot	1.0000
13	0.0000
3	0.6842
un#nid#pour#quoi#faire	1.0000
31	0.0000
trust	0.0000
type-spectacle	1.0000
sebastien#roux	1.0000
sasha#rau	0.0000
information	0.8276
ecole#d'#art	0.0000
chapelle#des#penitents#blancs	0.0000
18h30	0.0000
reservation	0.8889
17h00	0.8000
12/07	1.0000
23	0.6667
20/07	1.0000
136678	1.0000
sujets#a#vif#programmation#a#rosa#seulement	0.0000
obtus#nixe	1.0000
explique	0.0000
singulier	0.3500
type-billet	0.0000
09h00	0.0000
alternative	0.0000
la#danseuse#malade	0.5000
info-acces-salle	0.0000
10/07	1.0000
13/07	0.5000
sujets#a#vif#programme#a	0.0000
alain#platel	0.0000
frederic#boyer	0.0000
frank#van#laecke	0.0000
la#releve#des#dieux#par#les#pitres	0.0000

33	1.0000	
chloe#mons	0.6667	
pleintarif	0.6842	
piece-etat-complet	0.0000	
l'#homme#sans#qualites	0.6667	
temps-heure	0.5000	
joelle#gayot	0.0000	
numero-reference	0.6667	
11/07	1.0000	
gardenia	0.5000	
troisieme	0.0000	
susan#sontag	1.0000	
type-public	0.4286	
19	0.2500	
16h00	0.0000	
implique	0.0000	
112557	0.0000	
110550	0.0000	
cindy#van#acker	0.0000	
boris#charmatz	0.0000	
ludovic#lagarde	0.5000	
18/07	1.0000	
18	1.0000	
guy#cassiers	0.0000	
superieur	0.0000	
20h00	0.8889	
22/07	0.7143	
gdra	0.0000	
piece-resume	0.0000	
la#tragedie#du#roi#richard#deux	0.6667	
baal	0.5000	
21h00	1.0000	
repetition-demande	0.6000	
nom-lieu	0.0000	
12h00	0.0000	
anna#viebrock	0.0000	
info-auteur	0.0000	
14h00	0.5000	
sujets#a#vif	1.0000	
la#vingt#cinquieme#heure#adieu	1.0000	
21h30	1.0000	
jesaispas	0.6667	
piece-nom-auteur	0.7500	
entreelibre	0.0000	
11h00	0.5000	
catherine#marnas	0.3333	
046230	0.0000	
lectures#d'#ecrivains	0.0000	
concert#dessine	1.0000	
dernier	1.0000	
061301	0.0000	
info-tarif	0.0000	
piece	0.4828	
pluriel	0.2000	
16h30	0.0000	
sujets#a#vif#programmation#b#black#monde	1.0000	
nicolas#truong	1.0000	
la#vingt#cinquieme#heure#dors#toi	0.0000	
sujets#a#vif#programmation#c#une#semaine#d'#art#en#avignon	0.0000	
4	0.7857	
26/07	0.5714	
evenement	0.4167	
piece-duree	1.0000	
big#bang	1.0000	
nom-piece	0.3333	
paiement-montant-entier	0.6000	
christoph#marthaler	0.0000	
julie#andree#t	0.6667	

19h00	0.5000			
27/07	1.0000			
07/07	0.0000			
23h00	0.8000			
27	1.0000			
info-salle	0.6667			
113562	0.0000			
21/07	1.0000			
france#culture#en#public	1.0000			
19/07	1.0000			
jean#lambert#wild	0.3333			
oui	0.9379			
22h00	1.0000			
theatre#des#idees	1.0000			
agnes#sourdillon	0.5000			
info-acteur	0.0000			
jonathan#capdevielle	1.0000			
047231	0.0000			
car#j'#etais#avec#eux#tout#le#temps	0.0000			
modification	0.6364			
gertrude#stein	1.0000			
la#mort#d'#adam	0.7143			
18h00	0.8750			
6	0.7222			
Sujets#a#vif#programmation#a#la#releve#des#dieux#par#les#pitres		1.0000		
opposition	1.0000			
non	1.0000			
premier	0.2000			
la#casa#de#la#fuerza	1.0000			
info-piece	0.0000			
micro	0.0000			
theatre	0.0000			
2	0.8462			
undetermined	0.0000			
restriction	0.0000			
0	0.8333			
chouf#ouchouf	0.0000			
14/07	1.0000			
addition	0.3750			
euro	0.7500			
celia#houdart	1.0000			
l'#orchestre#perdu	1.0000			
inferieur	0.0000			
23/07	1.0000			
nb-billets	0.4286			
pascal#dusapin	1.0000			
553	0.0000			
1	0.6500			
15h00	0.8333			
ecoles#au#festival	0.0000			
25	1.0000			
24/07	1.0000			
info-placement	0.1667			
deuxieme	0.2500			
not#waterproof	0.7500			
la#vingt#cinquieme#heure#un#mage#en#ete	0.0000			
concert	0.0000			
07	0.0000			
my#secret#garden	0.0000			
olivia#grandville	0.0000			
philippe#menard	1.0000			
24	0.0000			
7	0.8571			

Slot-value prec/recall/f1

	precision	recall	f1-score	support
	0.0000	0.0000	0.0000	0.008692

ANNEXE C. RÉSULTATS DE L'ÉVALUATION POUR TF-SEQ2SEQ

0	0.9346	0.8333	0.8811	0.008692
021101	0.0000	0.0000	0.0000	0.0
046230	0.0000	0.0000	0.0000	0.008692
047231	0.0000	0.0000	0.0000	0.008692
052056	0.0000	0.0000	0.0000	0.0
061301	0.0000	0.0000	0.0000	0.008692
07	0.0000	0.0000	0.0000	0.008692
07/07	0.0000	0.0000	0.0000	0.008692
073361	0.0000	0.0000	0.0000	0.0
08/07	0.8573	0.8750	0.8661	0.008692
09	0.0000	0.0000	0.0000	0.008692
09/07	0.9972	1.0000	0.9986	0.008692
09h00	0.0000	0.0000	0.0000	0.008692
1	0.8577	0.6500	0.7395	0.008692
10	0.0000	0.0000	0.0000	0.0
10/07	1.0000	1.0000	1.0000	0.008692
11/07	1.0000	1.0000	1.0000	0.008692
110550	0.0000	0.0000	0.0000	0.008692
111554	0.0000	0.0000	0.0000	0.0
112557	0.0000	0.0000	0.0000	0.008692
113562	0.0000	0.0000	0.0000	0.008692
11h00	1.0000	0.5000	0.6667	0.008692
12/07	1.0000	1.0000	1.0000	0.008692
125196	0.0000	0.0000	0.0000	0.0
12h00	0.0000	0.0000	0.0000	0.008692
13	0.0000	0.0000	0.0000	0.008692
13/07	1.0000	0.5000	0.6667	0.008692
136678	1.0000	1.0000	1.0000	0.008692
14/07	1.0000	1.0000	1.0000	0.008692
14h00	1.0000	0.5000	0.6667	0.008692
15/07	1.0000	1.0000	1.0000	0.008692
15h00	0.4539	0.8333	0.5877	0.008692
15h30	0.0000	0.0000	0.0000	0.008692
16	1.0000	0.3333	0.5000	0.008692
16/07	1.0000	0.6667	0.8000	0.008692
16h00	0.0000	0.0000	0.0000	0.008692
16h30	0.0000	0.0000	0.0000	0.008692
17	0.0000	0.0000	0.0000	0.0
17/07	1.0000	1.0000	1.0000	0.008692
17h00	0.8780	0.8000	0.8372	0.008692
18	1.0000	1.0000	1.0000	0.008692
18/07	1.0000	1.0000	1.0000	0.008692
18h00	0.3535	0.8750	0.5036	0.008692
18h30	0.0000	0.0000	0.0000	0.008692
19	0.9679	0.2500	0.3974	0.008692
19/07	0.9945	1.0000	0.9972	0.008692
19h00	0.9945	0.5000	0.6654	0.008692
2	0.8188	0.8462	0.8322	0.008692
20/07	0.9972	1.0000	0.9986	0.008692
2010	0.9799	0.9444	0.9619	0.008692
20h00	0.9969	0.8889	0.9398	0.008692
20h30	0.0000	0.0000	0.0000	0.0
21	0.6630	1.0000	0.7974	0.008692
21/07	0.9972	1.0000	0.9986	0.008692
21h00	1.0000	1.0000	1.0000	0.008692
21h30	1.0000	1.0000	1.0000	0.008692
22/07	1.0000	0.7143	0.8333	0.008692
22h00	0.9972	1.0000	0.9986	0.008692
23	0.3993	0.6667	0.4995	0.008692
23/07	1.0000	1.0000	1.0000	0.008692
23h00	0.4068	0.8000	0.5393	0.008692
24	0.0000	0.0000	0.0000	0.008692
24/07	1.0000	1.0000	1.0000	0.008692
25	1.0000	1.0000	1.0000	0.008692
25/07	1.0000	1.0000	1.0000	0.008692
26/07	1.0000	0.5714	0.7273	0.008692
27	0.9972	1.0000	0.9986	0.008692
27/07	1.0000	1.0000	1.0000	0.008692

	3	0.7899	0.6842	0.7333	0.008692
	31	0.0000	0.0000	0.0000	0.008692
	33	1.0000	1.0000	1.0000	0.008692
	38	0.9963	0.7500	0.8558	0.008692
	4	0.8019	0.7857	0.7937	0.008692
	5	1.0000	0.8333	0.9091	0.008692
	553	0.0000	0.0000	0.0000	0.008692
	6	0.3648	0.7222	0.4847	0.008692
	7	0.9968	0.8571	0.9217	0.008692
	8	0.9935	0.8462	0.9139	0.008692
	addition	0.2492	0.3750	0.2994	0.008692
	agnes#sourdillon	1.0000	0.5000	0.6667	0.008692
	alain#plate1	0.0000	0.0000	0.0000	0.008692
	alternative	0.0000	0.0000	0.0000	0.008692
	anna#viebrock	0.0000	0.0000	0.0000	0.008692
	annulation	0.7143	0.5000	0.5882	0.008692
	ariane#ascaride	0.0000	0.0000	0.0000	0.008692
	attente	0.0000	0.0000	0.0000	0.0
	baal	1.0000	0.5000	0.6667	0.008692
	bal#du#quatorze#juillet	0.0000	0.0000	0.0000	0.0
	big#bang	1.0000	1.0000	1.0000	0.008692
	boris#charmatz	0.0000	0.0000	0.0000	0.008692
	car#j'#etais#avec#eux#tout#le#temps	0.0000	0.0000	0.0000	0.008692
	catherine#marnas	0.3636	0.3333	0.3478	0.008692
	celia#houdart	1.0000	1.0000	1.0000	0.008692
	chapelle#des#penitents#blancs	0.0000	0.0000	0.0000	0.008692
	chloe#mons	1.0000	0.6667	0.8000	0.008692
	chouf#ouchouf	0.0000	0.0000	0.0000	0.008692
	christoph#marthaler	0.0000	0.0000	0.0000	0.008692
	christophe#fiat	0.0000	0.0000	0.0000	0.0
	christophe#huysman	0.0000	0.0000	0.0000	0.0
	cindy#van#acker	0.0000	0.0000	0.0000	0.008692
	comment#ai#je#pu#tenir	1.0000	1.0000	1.0000	0.008692
	concert	0.0000	0.0000	0.0000	0.008692
	concert#dessine	1.0000	1.0000	1.0000	0.008692
	confirmation-annonce	0.9904	0.8571	0.9190	0.008692
	confirmation-demande	0.0000	0.0000	0.0000	0.008692
	danse	0.0000	0.0000	0.0000	0.008692
	dernier	1.0000	1.0000	1.0000	0.008692
	deuxieme	0.9891	0.2500	0.3991	0.008692
	ecole#d'#art	0.0000	0.0000	0.0000	0.008692
	ecoles#au#festival	0.0000	0.0000	0.0000	0.008692
	entreelibre	0.0000	0.0000	0.0000	0.008692
	etat-piece-complet	0.1588	0.2857	0.2041	0.008692
	euro	0.9855	0.7500	0.8518	0.008692
	evenement	0.6580	0.4167	0.5102	0.008692
	explique	0.0000	0.0000	0.0000	0.008692
	falk#richter	0.0000	0.0000	0.0000	0.0
	faustin#linyekula	0.0000	0.0000	0.0000	0.008692
	france#culture#en#public	0.4993	1.0000	0.6661	0.008692
	frank#van#laecke	0.0000	0.0000	0.0000	0.008692
	frederic#boyer	0.0000	0.0000	0.0000	0.008692
	gardenia	0.3333	0.5000	0.4000	0.008692
	gdra	0.0000	0.0000	0.0000	0.008692
	gertrude#stein	0.7500	1.0000	0.8571	0.008692
	gisele#vienne	0.0000	0.0000	0.0000	0.0
	guy#cassiers	0.0000	0.0000	0.0000	0.008692
	implique	0.0000	0.0000	0.0000	0.008692
	inferieur	0.0000	0.0000	0.0000	0.008692
	info-acces-mobred	0.0000	0.0000	0.0000	0.008692
	info-acces-salle	0.0000	0.0000	0.0000	0.008692
	info-acteur	0.0000	0.0000	0.0000	0.008692
	info-auteur	0.0000	0.0000	0.0000	0.008692
	info-piece	0.0000	0.0000	0.0000	0.008692
	info-placement	0.5385	0.1667	0.2545	0.008692
	info-salle	0.6434	0.6667	0.6548	0.008692
	info-site-web	0.0000	0.0000	0.0000	0.0
	info-tarif	0.0000	0.0000	0.0000	0.008692

ANNEXE C. RÉSULTATS DE L'ÉVALUATION POUR TF-SEQ2SEQ

information	0.9901	0.8276	0.9016	0.008692
jean#baptiste#sastre	0.9945	0.5000	0.6654	0.008692
jean#lambert#wild	0.9918	0.3333	0.4990	0.008692
jesaispas	1.0000	0.6667	0.8000	0.008692
joelle#gayot	0.0000	0.0000	0.0000	0.008692
jonathan#capdevielle	1.0000	1.0000	1.0000	0.008692
jour	0.0000	0.0000	0.0000	0.008692
julie#andree#t	0.9959	0.6667	0.7987	0.008692
julien#fournet	0.0000	0.0000	0.0000	0.0
l'#homme#sans#qualites	1.0000	0.6667	0.8000	0.008692
l'#orchestre#perdu	1.0000	1.0000	1.0000	0.008692
la#casa#de#la#fuerza	1.0000	1.0000	1.0000	0.008692
la#danseuse#malade	0.9945	0.5000	0.6654	0.008692
la#mort#d'#adam	0.4167	0.7143	0.5263	0.008692
la#releve#des#dieux#par#les#pitres	0.0000	0.0000	0.0000	0.008692
la#tragedie#du#roi#richard#deux	0.8235	0.6667	0.7368	0.008692
la#vingt#cinquieme#heure	0.5455	0.6000	0.5714	0.008692
la#vingt#cinquieme#heure#adieu	0.9891	1.0000	0.9945	0.008692
la#vingt#cinquieme#heure#cheval	0.0000	0.0000	0.0000	0.0
la#vingt#cinquieme#heure#dechifffrage	0.0000	0.0000	0.0000	0.0
la#vingt#cinquieme#heure#dors#toi	0.0000	0.0000	0.0000	0.008692
la#vingt#cinquieme#heure#un#mage#en#ete	0.0000	0.0000	0.0000	0.008692
lectures#d'#ecrivains	0.0000	0.0000	0.0000	0.008692
ludovic#lagarde	0.7059	0.5000	0.5854	0.008692
mathieu#bertholet	0.0000	0.0000	0.0000	0.008692
micro	0.0000	0.0000	0.0000	0.008692
miroirs#du#reel	1.0000	0.3333	0.5000	0.008692
modification	0.9957	0.6364	0.7765	0.008692
musique	0.0000	0.0000	0.0000	0.0
my#secret#garden	0.0000	0.0000	0.0000	0.008692
nb-billets	0.1723	0.4286	0.2458	0.008692
nicolas#truong	1.0000	1.0000	1.0000	0.008692
nom-lieu	0.0000	0.0000	0.0000	0.008692
nom-piece	0.7273	0.3333	0.4572	0.008692
nombre	0.0000	0.0000	0.0000	0.0
non	0.9850	1.0000	0.9925	0.008692
not#waterproof	1.0000	0.7500	0.8571	0.008692
numero-reference	0.9959	0.6667	0.7987	0.008692
obtus#nixe	1.0000	1.0000	1.0000	0.008692
olivia#grandville	0.0000	0.0000	0.0000	0.008692
olivier#cadiot	1.0000	1.0000	1.0000	0.008692
opposition	0.6618	1.0000	0.7965	0.008692
oui	0.7267	0.9379	0.8189	0.008692
paiement-montant-entier	0.2734	0.6000	0.3757	0.008692
pascal#dusapin	1.0000	1.0000	1.0000	0.008692
philippe#menard	1.0000	1.0000	1.0000	0.008692
piece	0.7634	0.4828	0.5915	0.008692
piece-duree	0.8708	1.0000	0.9309	0.008692
piece-etat-complet	0.0000	0.0000	0.0000	0.008692
piece-nom-auteur	0.6794	0.7500	0.7130	0.008692
piece-resume	0.0000	0.0000	0.0000	0.008692
pierre#alferi	0.0000	0.0000	0.0000	0.0
pierre#baux	0.0000	0.0000	0.0000	0.0
pleintarif	0.8882	0.6842	0.7730	0.008692
pluriel	0.8375	0.2000	0.3229	0.008692
premier	0.9731	0.2000	0.3318	0.008692
repetition-demande	0.9954	0.6000	0.7487	0.008692
reservation	0.9293	0.8889	0.9086	0.008692
restriction	0.0000	0.0000	0.0000	0.008692
retrait-billet	0.0000	0.0000	0.0000	0.0
rien	1.0000	0.8889	0.9412	0.008692
rodolphe#burger	0.0000	0.0000	0.0000	0.0
samedi	0.0000	0.0000	0.0000	0.008692
sasha#rau	0.0000	0.0000	0.0000	0.008692
schutz#vor#der#zukunft	0.0000	0.0000	0.0000	0.008692
sebastien#roux	1.0000	1.0000	1.0000	0.008692
singularites#ordinaires	0.0000	0.0000	0.0000	0.008692
singulier	0.5127	0.3500	0.4160	0.008692

stanislas#nordey	0.0000	0.0000	0.0000	0.0
sujets#a#vif	1.0000	1.0000	1.0000	0.008692
sujets#a#vif#programmation#a#la#releve#des#dieux#par#les#pitres	1.0000	1.0000	1.0000	0.008692
sujets#a#vif#programmation#a#rosa#seulement	0.0000	0.0000	0.0000	0.008692
sujets#a#vif#programmation#b#black#monde	0.9972	1.0000	0.9986	0.008692
sujets#a#vif#programmation#c#une#semaine#d'#art#en#avignon	0.0000	0.0000	0.0000	0.008692
sujets#a#vif#programmation#d#au#contraire	0.0000	0.0000	0.0000	0.0
sujets#a#vif#programme#a	0.0000	0.0000	0.0000	0.008692
superieur	0.0000	0.0000	0.0000	0.008692
susan#sontag	1.0000	1.0000	1.0000	0.008692
tarifreduit	0.7029	0.6944	0.6986	0.008692
temps-date	0.4980	0.8636	0.6317	0.008692
temps-heure	0.3203	0.5000	0.3905	0.008692
theatre	0.0000	0.0000	0.0000	0.008692
theatre#des#idees	0.9945	1.0000	0.9972	0.008692
troisieme	0.0000	0.0000	0.0000	0.008692
trust	0.0000	0.0000	0.0000	0.008692
type-billet	0.0000	0.0000	0.0000	0.008692
type-placement	0.0000	0.0000	0.0000	0.008692
type-public	0.9936	0.4286	0.5988	0.008692
type-spectacle	0.8750	1.0000	0.9333	0.008692
un#nid#pour#quoi#faire	0.4545	1.0000	0.6250	0.008692
undetermined	0.0000	0.0000	0.0000	0.008692
vincent#courtois	0.0000	0.0000	0.0000	0.0
avg / total	0.5279	0.4735	0.4817	1.755963

C.2 Appris sur l'artificiel et testé sur VocADom : mode mots

C.2.1 Intentions

Métriques non-pondérées

Intent Accuracy				0.8420
Intent Accuracy			per category	
set_device_group				0.9573
check_device_group				0.0000
set_device				0.9644
check_device				0.0000
set_room_property				0.0000
set_device_property				0.0000
Intent prec/recall/f1				
	precision	recall	f1-score	support
	0.0000	0.0000	0.0000	0
check_device	0.0000	0.0000	0.0000	64
check_device_group	0.0000	0.0000	0.0000	119
contact	0.0000	0.0000	0.0000	0
get_room_property	0.0000	0.0000	0.0000	0
get_world_property	0.0000	0.0000	0.0000	0
set_device	0.9038	0.9644	0.9331	926
set_device_group	0.8286	0.9573	0.8883	515
set_device_property	0.0000	0.0000	0.0000	6
set_room_property	0.0000	0.0000	0.0000	16
avg / total	0.7677	0.8420	0.8029	1646

Métriques pondérées

Intent Accuracy			0.3203
Intent Accuracy			per category
set_device_group			0.9573
check_device_group			0.0000

set_device				0.9644
check_device				0.0000
set_room_property				0.0000
set_device_property				0.0000
Intent prec/recall/f1				
	precision	recall	f1-score	support
	0.0000	0.0000	0.0000	0.0
check_device	0.0000	0.0000	0.0000	3.902946381665261
check_device_group	0.0000	0.0000	0.0000	3.90294638166526
contact	0.0000	0.0000	0.0000	0.0
get_room_property	0.0000	0.0000	0.0000	0.0
get_world_property	0.0000	0.0000	0.0000	0.0
set_device	0.3168	0.9644	0.4769	3.9029463816652323
set_device_group	0.4594	0.9573	0.6209	3.90294638166524
set_device_property	0.0000	0.0000	0.0000	3.9029463816652656
set_room_property	0.0000	0.0000	0.0000	3.902946381665266
avg / total	0.1294	0.3203	0.1830	23.417678289991525

C.2.2 Slot-labels

Métriques non-pondérées

Slot-label Accuracy				0.7282
Slot-label Accuracy				per category
				0.0018
action				0.9877
device-component				0.0000
location-relative				0.0000
value-numeric				0.0000
location-house				0.0000
location-floor				0.0190
device				0.9717
location-inroom				0.0000
room-property				0.3529
device-setting				0.0272
location-room				0.9836
Slot-label prec/recall/f1				
	precision	recall	f1-score	support
	0.0012	0.0018	0.0014	571
action	0.8941	0.9877	0.9386	1462
device	0.9918	0.9717	0.9816	1624
device-component	0.0000	0.0000	0.0000	5
device-setting	0.1220	0.0272	0.0444	184
location-floor	0.5556	0.0190	0.0368	526
location-house	0.0000	0.0000	0.0000	1
location-inroom	0.0000	0.0000	0.0000	22
location-relative	0.0000	0.0000	0.0000	2
location-room	0.7026	0.9836	0.8197	670
person-occupation	0.0000	0.0000	0.0000	0
person-relation	0.0000	0.0000	0.0000	0
room-property	0.3529	0.3529	0.3529	17
value-artist	0.0000	0.0000	0.0000	0
value-numeric	0.0000	0.0000	0.0000	1
value-qualitative	0.0000	0.0000	0.0000	0
world-property	0.0000	0.0000	0.0000	0
avg / total	0.7296	0.7282	0.6981	5085

Métriques pondérées

Slot-label Accuracy	0.2787
---------------------	--------

Slot-label Accuracy				per category
				0.0018
action				0.9877
device-component				0.0000
location-relative				0.0000
value-numeric				0.0000
location-house				0.0000
location-floor				0.0190
device				0.9717
location-inroom				0.0000
room-property				0.3529
device-setting				0.0272
location-room				0.9836
Slot-label prec/recall/f1				
	precision	recall	f1-score	support
	0.0002	0.0018	0.0004	0.3550937623315847
action	0.7673	0.9877	0.8637	0.3550937623315749
device	0.9771	0.9717	0.9744	0.35509376233158785
device-component	0.0000	0.0000	0.0000	0.35509376233158785
device-setting	0.3012	0.0272	0.0499	0.3550937623315871
location-floor	0.5757	0.0190	0.0368	0.355093762331587
location-house	0.0000	0.0000	0.0000	0.3550937623315879
location-inroom	0.0000	0.0000	0.0000	0.3550937623315878
location-relative	0.0000	0.0000	0.0000	0.3550937623315879
location-room	0.6681	0.9836	0.7957	0.3550937623315908
person-occupation	0.0000	0.0000	0.0000	0.0
person-relation	0.0000	0.0000	0.0000	0.0
room-property	0.9482	0.3529	0.5144	0.35509376233158785
value-artist	0.0000	0.0000	0.0000	0.0
value-numeric	0.0000	0.0000	0.0000	0.3550937623315879
value-qualitative	0.0000	0.0000	0.0000	0.0
world-property	0.0000	0.0000	0.0000	0.0
avg / total	0.3532	0.2787	0.2696	4.2611251479790395

C.2.3 Slot-values

Métriques non-pondérées

Slot-value Accuracy	0.4344
Slot-value Accuracy	per category
	0.0105
middle	0.0000
tv_music_player	0.4130
turn_off	0.3482
change	0.0000
turn_on	0.8618
turn_up	0.4375
channel	0.0000
radio	0.4054
1	0.0073
close	0.7768
off	0.0000
light	0.8793
curtain	0.0127
shower	0.0000
volume	0.0000
door	0.0000
wc	0.0000
raise	0.2289
study	0.9136
bedroom	0.9379
0	0.0079

lower	0.3188
window	0.5667
stairs	0.0000
turn_down	0.0189
open	0.9554
kettle	0.4328
heating	0.0000
2	0.0000
kitchen	0.8696
shutter	0.8644
right	0.0000
temperature	0.2941
living_room	1.0000
on	0.0000
fan	0.3857
blind	0.7290
ceiling	0.0000
stop	0.0687
house	0.0000
closed	0.0000
night_table	0.0000
opened	0.0471
bathroom	0.6024

Slot-value	prec/recall/f1			
	precision	recall	f1-score	support
	0.0073	0.0105	0.0086	571
0	0.1176	0.0079	0.0148	253
1	0.6667	0.0073	0.0145	273
2	0.0000	0.0000	0.0000	1
a_little	0.0000	0.0000	0.0000	0
a_lot	0.0000	0.0000	0.0000	0
artistname	0.0000	0.0000	0.0000	0
bathroom	0.9615	0.6024	0.7407	83
bedroom	0.7432	0.9379	0.8293	290
blind	0.7488	0.7290	0.7388	642
ceiling	0.0000	0.0000	0.0000	14
change	0.0000	0.0000	0.0000	3
channel	0.0000	0.0000	0.0000	3
close	0.6932	0.7768	0.7326	224
closed	0.0000	0.0000	0.0000	60
contact	0.0000	0.0000	0.0000	0
curtain	0.1429	0.0127	0.0234	157
daughter	0.0000	0.0000	0.0000	0
doctor	0.0000	0.0000	0.0000	0
door	0.0000	0.0000	0.0000	47
drawer	0.0000	0.0000	0.0000	0
fan	0.7714	0.3857	0.5143	70
heating	0.0000	0.0000	0.0000	18
hood	0.0000	0.0000	0.0000	0
house	0.0000	0.0000	0.0000	1
kettle	0.5577	0.4328	0.4874	67
kitchen	0.3891	0.8696	0.5376	115
light	0.9148	0.8793	0.8967	232
living_room	0.4464	1.0000	0.6173	25
lower	0.4889	0.3188	0.3860	207
middle	0.0000	0.0000	0.0000	1
music_player	0.0000	0.0000	0.0000	0
night_table	0.0000	0.0000	0.0000	7
off	0.0000	0.0000	0.0000	13
on	0.0000	0.0000	0.0000	26
open	0.5288	0.9554	0.6808	202
opened	0.1429	0.0471	0.0708	85
pause	0.0000	0.0000	0.0000	0
play_stop	0.0000	0.0000	0.0000	0
radio	0.6000	0.4054	0.4839	148
raise	0.1508	0.2289	0.1818	83

restart	0.0000	0.0000	0.0000	0
right	0.0000	0.0000	0.0000	1
roomba	0.0000	0.0000	0.0000	0
shower	0.0000	0.0000	0.0000	2
shutter	1.0000	0.8644	0.9273	59
stairs	0.0000	0.0000	0.0000	2
start_up	0.0000	0.0000	0.0000	0
stop	0.6923	0.0687	0.1250	131
study	0.3663	0.9136	0.5230	81
temperature	0.3846	0.2941	0.3333	17
time	0.0000	0.0000	0.0000	0
true	0.0000	0.0000	0.0000	0
turn_down	0.0213	0.0189	0.0200	53
turn_off	0.6757	0.3482	0.4596	359
turn_on	0.6931	0.8618	0.7683	152
turn_up	0.9130	0.4375	0.5915	48
tv_music_player	0.5135	0.4130	0.4578	92
volume	0.0000	0.0000	0.0000	2
washing_machine	0.0000	0.0000	0.0000	0
wc	0.0000	0.0000	0.0000	75
window	0.6071	0.5667	0.5862	90
avg / total	0.4978	0.4344	0.4220	5085

Métriques pondérées

Slot-value Accuracy	0.2977
Slot-value Accuracy	per category
	0.0105
middle	0.0000
tv_music_player	0.4130
turn_off	0.3482
change	0.0000
turn_on	0.8618
turn_up	0.4375
channel	0.0000
radio	0.4054
1	0.0073
close	0.7768
off	0.0000
light	0.8793
curtain	0.0127
shower	0.0000
volume	0.0000
door	0.0000
wc	0.0000
raise	0.2289
study	0.9136
bedroom	0.9379
0	0.0079
lower	0.3188
window	0.5667
stairs	0.0000
turn_down	0.0189
open	0.9554
kettle	0.4328
heating	0.0000
2	0.0000
kitchen	0.8696
shutter	0.8644
right	0.0000
temperature	0.2941
living_room	1.0000
on	0.0000
fan	0.3857
blind	0.7290
ceiling	0.0000

stop	0.0687
house	0.0000
closed	0.0000
night_table	0.0000
opened	0.0471
bathroom	0.6024

Slot-value	prec/recall/f1	recall	f1-score	support
	precision			
	0.0006	0.0105	0.0012	0.14430450996259314
0	0.1808	0.0079	0.0151	0.14430450996259295
1	0.6496	0.0073	0.0145	0.14430450996259225
2	0.0000	0.0000	0.0000	0.14430450996259267
a_little	0.0000	0.0000	0.0000	0.0
a_lot	0.0000	0.0000	0.0000	0.0
artistname	0.0000	0.0000	0.0000	0.0
bathroom	0.9887	0.6024	0.7487	0.14430450996259253
bedroom	0.6233	0.9379	0.7489	0.14430450996259303
blind	0.3198	0.7290	0.4446	0.14430450996259336
ceiling	0.0000	0.0000	0.0000	0.14430450996259264
change	0.0000	0.0000	0.0000	0.14430450996259267
channel	0.0000	0.0000	0.0000	0.14430450996259267
close	0.5528	0.7768	0.6459	0.144304509962593
closed	0.0000	0.0000	0.0000	0.14430450996259275
contact	0.0000	0.0000	0.0000	0.0
curtain	0.0395	0.0127	0.0193	0.14430450996259286
daughter	0.0000	0.0000	0.0000	0.0
doctor	0.0000	0.0000	0.0000	0.0
door	0.0000	0.0000	0.0000	0.1443045099625927
drawer	0.0000	0.0000	0.0000	0.0
fan	0.9311	0.3857	0.5455	0.1443045099625927
heating	0.0000	0.0000	0.0000	0.14430450996259267
hood	0.0000	0.0000	0.0000	0.0
house	0.0000	0.0000	0.0000	0.14430450996259267
kettle	0.3735	0.4328	0.4010	0.14430450996259273
kitchen	0.5006	0.8696	0.6354	0.1443045099625924
light	0.8331	0.8793	0.8556	0.14430450996259206
living_room	0.8666	1.0000	0.9285	0.14430450996259267
lower	0.4289	0.3188	0.3658	0.14430450996259206
middle	0.0000	0.0000	0.0000	0.14430450996259267
music_player	0.0000	0.0000	0.0000	0.0
night_table	0.0000	0.0000	0.0000	0.1443045099625927
off	0.0000	0.0000	0.0000	0.1443045099625927
on	0.0000	0.0000	0.0000	0.14430450996259267
open	0.5471	0.9554	0.6958	0.1443045099625922
opened	0.5282	0.0471	0.0864	0.14430450996259267
pause	0.0000	0.0000	0.0000	0.0
play_stop	0.0000	0.0000	0.0000	0.0
radio	0.4432	0.4054	0.4234	0.14430450996259278
raise	0.2541	0.2289	0.2409	0.14430450996259253
restart	0.0000	0.0000	0.0000	0.0
right	0.0000	0.0000	0.0000	0.14430450996259267
roomba	0.0000	0.0000	0.0000	0.0
shower	0.0000	0.0000	0.0000	0.14430450996259267
shutter	1.0000	0.8644	0.9273	0.14430450996259275
stairs	0.0000	0.0000	0.0000	0.14430450996259267
start_up	0.0000	0.0000	0.0000	0.0
stop	0.6598	0.0687	0.1244	0.1443045099625927
study	0.6528	0.9136	0.7615	0.14430450996259298
temperature	0.9467	0.2941	0.4488	0.14430450996259273
time	0.0000	0.0000	0.0000	0.0
true	0.0000	0.0000	0.0000	0.0
turn_down	0.0189	0.0189	0.0189	0.14430450996259273
turn_off	0.3057	0.3482	0.3255	0.14430450996259206
turn_on	0.5512	0.8618	0.6724	0.1443045099625925
turn_up	0.9813	0.4375	0.6052	0.14430450996259267
tv_music_player	0.8324	0.4130	0.5521	0.14430450996259256

volume	0.0000	0.0000	0.0000	0.14430450996259267
washing_machine	0.0000	0.0000	0.0000	0.0
wc	0.0000	0.0000	0.0000	0.14430450996259275
window	0.6655	0.5667	0.6121	0.14430450996259278
avg / total	0.3483	0.2977	0.2859	6.49370294831667

C.3 Appris sur l'artificiel et testé sur VocADom : mode caractères

C.3.1 Intentions

Métriques non-pondérées

Intent Accuracy 0.7278

Intent Accuracy	per category
set_room_property	0.0000
check_device_group	0.0420
check_device	0.0156
set_device_group	0.7689
set_device_property	0.0000
set_device	0.8596

Intent prec/recall/f1	precision	recall	f1-score	support
chece_gyvice	0.0000	0.0000	0.0000	0
check_device	0.0233	0.0156	0.0187	64
check_device_group	0.1724	0.0420	0.0676	119
check_device_property	0.0000	0.0000	0.0000	0
chect	0.0000	0.0000	0.0000	0
chect_device_group	0.0000	0.0000	0.0000	0
contact	0.0000	0.0000	0.0000	0
contact_device_group	0.0000	0.0000	0.0000	0
get_ce	0.0000	0.0000	0.0000	0
get_ce_tvev_ccopentact	0.0000	0.0000	0.0000	0
get_corld-property	0.0000	0.0000	0.0000	0
get_corld-property	0.0000	0.0000	0.0000	0
get_cortem-property	0.0000	0.0000	0.0000	0
get_device	0.0000	0.0000	0.0000	0
get_room_property	0.0000	0.0000	0.0000	0
get_world-property	0.0000	0.0000	0.0000	0
getact	0.0000	0.0000	0.0000	0
set_device	0.7812	0.8596	0.8185	926
set_device_group	0.8820	0.7689	0.8216	515
set_device_property	0.0000	0.0000	0.0000	6
set_room_property	0.0000	0.0000	0.0000	16
set_roorlacturn_off	0.0000	0.0000	0.0000	0
set_roorld-property	0.0000	0.0000	0.0000	0
avg / total	0.7288	0.7278	0.7231	1646

Métriques pondérées

Intent Accuracy 0.2810

Intent Accuracy	per category
set_room_property	0.0000
check_device_group	0.0420
check_device	0.0156
set_device_group	0.7689
set_device_property	0.0000
set_device	0.8596

Intent	prec/recall/f1	precision	recall	f1-score	support
		0.0000	0.0000	0.0000	0.0
	chece_gyvice	0.1307	0.0156	0.0279	3.902946381665261
	check_device	0.2178	0.0420	0.0704	3.90294638166526
	check_device_group	0.0000	0.0000	0.0000	0.0
	check_device_property	0.0000	0.0000	0.0000	0.0
	chect	0.0000	0.0000	0.0000	0.0
	chect_device_group	0.0000	0.0000	0.0000	0.0
	contact	0.0000	0.0000	0.0000	0.0
	contact_device_group	0.0000	0.0000	0.0000	0.0
	get_ce	0.0000	0.0000	0.0000	0.0
	get_ce_tvev_ccopentact	0.0000	0.0000	0.0000	0.0
	get_corld-property	0.0000	0.0000	0.0000	0.0
	get_corld-property	0.0000	0.0000	0.0000	0.0
	get_cortem-property	0.0000	0.0000	0.0000	0.0
	get_device	0.0000	0.0000	0.0000	0.0
	get_room-property	0.0000	0.0000	0.0000	0.0
	get_world-property	0.0000	0.0000	0.0000	0.0
	getact	0.0000	0.0000	0.0000	0.0
	set_device	0.2394	0.8596	0.3745	3.9029463816652323
	set_device_group	0.5999	0.7689	0.6740	3.90294638166524
	set_device-property	0.0000	0.0000	0.0000	3.902946381665266
	set_room-property	0.0000	0.0000	0.0000	3.9029463816652665
	set_roorlacturn_off	0.0000	0.0000	0.0000	0.0
	set_roorld-property	0.0000	0.0000	0.0000	0.0
	avg / total	0.1980	0.2810	0.1911	23.417678289991525

C.3.2 Slot-labels

Métriques non-pondérées

Slot-label Accuracy 0.6880

Slot-label Accuracy	per category
	0.0000
room-property	0.1176
device-setting	0.0435
value-numeric	0.0000
location-inroom	0.0000
location-relative	0.0000
device-component	0.2000
device	0.9581
location-floor	0.1711
action	0.9891
location-house	0.0000
location-room	0.8552

Slot-label	prec/recall/f1	precision	recall	f1-score	support
		0.0000	0.0000	0.0000	829
	action	0.9066	0.9891	0.9460	1462
	device	0.9861	0.9581	0.9719	1624
	device-com	0.0000	0.0000	0.0000	0
	device-component	0.0145	0.2000	0.0270	5
	device-setting	1.0000	0.0435	0.0833	184
	l	0.0000	0.0000	0.0000	0
	lo	0.0000	0.0000	0.0000	0
	loc	0.0000	0.0000	0.0000	0
	locat	0.0000	0.0000	0.0000	0
	locati	0.0000	0.0000	0.0000	0
	locatio	0.0000	0.0000	0.0000	0
	location	0.0000	0.0000	0.0000	0
	location-	0.0000	0.0000	0.0000	0

location-f	0.0000	0.0000	0.0000	0
location-floor	0.8571	0.1711	0.2853	526
location-h	0.0000	0.0000	0.0000	0
location-ho	0.0000	0.0000	0.0000	0
location-hou	0.0000	0.0000	0.0000	0
location-hous	0.0000	0.0000	0.0000	0
location-house	0.0000	0.0000	0.0000	1
location-inroom	0.0000	0.0000	0.0000	22
location-relative	0.0000	0.0000	0.0000	2
location-roo	0.0000	0.0000	0.0000	0
location-room	0.5895	0.8552	0.6979	670
organization	0.0000	0.0000	0.0000	0
person-occupation	0.0000	0.0000	0.0000	0
person-relation	0.0000	0.0000	0.0000	0
room-croperty]	0.0000	0.0000	0.0000	0
room-property	0.4000	0.1176	0.1818	17
value-artist	0.0000	0.0000	0.0000	0
value-numeric	0.0000	0.0000	0.0000	1
value-qualitative	0.0000	0.0000	0.0000	0
avg / total	0.7418	0.6880	0.6733	5343

Métriques pondérées

Slot-label Accuracy 0.2779

Slot-label Accuracy per category

room-property	0.0000
device-setting	0.1176
value-numeric	0.0435
location-inroom	0.0000
location-relative	0.0000
device-component	0.2000
device	0.9581
location-floor	0.1711
action	0.9891
location-house	0.0000
location-room	0.8552

Slot-label prec/recall/f1

	precision	recall	f1-score	support
	0.0000	0.0000	0.0000	0.35516250069943345
action	0.8462	0.9891	0.9121	0.3551625006994314
device	0.9730	0.9581	0.9655	0.3551625006994309
device-com	0.0000	0.0000	0.0000	0.0
device-component	0.7092	0.2000	0.3120	0.355162500699427
device-setting	1.0000	0.0435	0.0833	0.35516250069942856
l	0.0000	0.0000	0.0000	0.0
lo	0.0000	0.0000	0.0000	0.0
loc	0.0000	0.0000	0.0000	0.0
locat	0.0000	0.0000	0.0000	0.0
locati	0.0000	0.0000	0.0000	0.0
locatio	0.0000	0.0000	0.0000	0.0
location	0.0000	0.0000	0.0000	0.0
location-	0.0000	0.0000	0.0000	0.0
location-f	0.0000	0.0000	0.0000	0.0
location-floor	0.9044	0.1711	0.2878	0.3551625006994261
location-h	0.0000	0.0000	0.0000	0.0
location-ho	0.0000	0.0000	0.0000	0.0
location-hou	0.0000	0.0000	0.0000	0.0
location-hous	0.0000	0.0000	0.0000	0.0
location-house	0.0000	0.0000	0.0000	0.35516250069942706
location-inroom	0.0000	0.0000	0.0000	0.35516250069942706
location-relative	0.0000	0.0000	0.0000	0.35516250069942706
location-roo	0.0000	0.0000	0.0000	0.0
location-room	0.6399	0.8552	0.7320	0.35516250069942223

organization	0.0000	0.0000	0.0000	0.0
person-occupation	0.0000	0.0000	0.0000	0.0
person-relation	0.0000	0.0000	0.0000	0.0
room-cropeerty]	0.0000	0.0000	0.0000	0.0
room-property	0.9702	0.1176	0.2098	0.3551625006994271
value-artist	0.0000	0.0000	0.0000	0.0
value-numeric	0.0000	0.0000	0.0000	0.35516250069942706
value-qualitative	0.0000	0.0000	0.0000	0.0
avg / total	0.5036	0.2779	0.2919	4.261950008393135

C.3.3 Slot-values

Métriques non-pondérées

Slot-value Accuracy	0.3881
Slot-value Accuracy	per category
kettle	0.0069
stop	0.5224
1	0.0687
house	0.0476
turn_on	0.0000
lower	0.7697
0	0.3333
off	0.2806
change	0.0000
on	0.0000
volume	0.0000
close	0.0000
kitchen	0.6875
bedroom	0.7478
open	0.8793
turn_down	0.6535
channel	0.0566
ceiling	0.0000
opened	0.0000
night_table	0.0941
closed	0.0000
door	0.0000
radio	0.1489
blind	0.2297
middle	0.6651
2	0.0000
wc	0.0000
study	0.0000
stairs	0.7531
right	0.0000
heating	0.0000
tv_music_player	0.0000
turn_up	0.2391
temperature	0.1667
bathroom	0.1176
window	0.8916
light	0.3444
living_room	0.8276
shutter	0.8800
fan	0.1695
shower	0.4143
raise	0.0000
turn_off	0.2530
curtain	0.3844
Slot-value prec/recall/f1	
	precision recall f1-score support

	0.0058	0.0069	0.0063	729	
0	0.9726	0.2806	0.4356		253
1	0.4333	0.0476	0.0858		273
2	0.0000	0.0000	0.0000		1
_roomba	0.0000	0.0000	0.0000		0
a_l	0.0000	0.0000	0.0000		0
a_little	0.0000	0.0000	0.0000		0
a_lot	0.0000	0.0000	0.0000		0
amevabetle	0.0000	0.0000	0.0000		0
arator	0.0000	0.0000	0.0000		0
arantistudy	0.0000	0.0000	0.0000		0
artist	0.0000	0.0000	0.0000		0
artistname	0.0000	0.0000	0.0000		0
artisttare	0.0000	0.0000	0.0000		0
b	0.0000	0.0000	0.0000		0
bathroom	0.8916	0.8916	0.8916		83
bed	0.0000	0.0000	0.0000		0
bedroo	0.0000	0.0000	0.0000		0
bedroom	0.9808	0.8793	0.9273		290
blind	0.8859	0.6651	0.7598		642
ceiling	0.0000	0.0000	0.0000		14
change	0.0000	0.0000	0.0000		3
channel	0.0000	0.0000	0.0000		3
close	0.9390	0.6875	0.7938		224
closed	0.0000	0.0000	0.0000		60
clupe	0.0000	0.0000	0.0000		0
cod	0.0000	0.0000	0.0000		0
contact	0.0000	0.0000	0.0000		0
corridor	0.0000	0.0000	0.0000		0
corrim	0.0000	0.0000	0.0000		0
cup	0.0000	0.0000	0.0000		0
cupantom	0.0000	0.0000	0.0000		0
cupboard	0.0000	0.0000	0.0000		0
curtain	0.0000	0.0000	0.0000		157
cy	0.0000	0.0000	0.0000		0
daugher	0.0000	0.0000	0.0000		0
daughter	0.0000	0.0000	0.0000		0
doctor	0.0000	0.0000	0.0000		0
door	0.3500	0.1489	0.2090		47
drawer	0.0000	0.0000	0.0000		0
emergency	0.0000	0.0000	0.0000		0
fan	0.5800	0.4143	0.4833		70
heating	0.0000	0.0000	0.0000		18
hood	0.0000	0.0000	0.0000		0
house	0.0000	0.0000	0.0000		1
kett_ume	0.0000	0.0000	0.0000		0
kettle	0.9459	0.5224	0.6731		67
kitche	0.0000	0.0000	0.0000		0
kitchen	0.7167	0.7478	0.7319		115
light	0.6057	0.8276	0.6995		232
living_r	0.0000	0.0000	0.0000		0
living_room	0.1023	0.8800	0.1833		25
low	0.0000	0.0000	0.0000		0
lower	0.7113	0.3333	0.4539		207
middle	0.0000	0.0000	0.0000		1
music_player	0.0000	0.0000	0.0000		0
night_table	0.0000	0.0000	0.0000		7
off	0.0000	0.0000	0.0000		13
on	0.0000	0.0000	0.0000		26
onen	0.0000	0.0000	0.0000		0
ope	0.0000	0.0000	0.0000		0
open	0.4648	0.6535	0.5432		202
opened	1.0000	0.0941	0.1720		85
play	0.0000	0.0000	0.0000		0
play_stop	0.0000	0.0000	0.0000		0
raatim	0.0000	0.0000	0.0000		0
radio	0.6182	0.2297	0.3350		148
rador	0.0000	0.0000	0.0000		0

raghce_	0.0000	0.0000	0.0000	0
raghce_m	0.0000	0.0000	0.0000	0
rain_	0.0000	0.0000	0.0000	0
raise	0.0802	0.2530	0.1217	83
rasic_p	0.0000	0.0000	0.0000	0
ratise	0.0000	0.0000	0.0000	0
rest	0.0000	0.0000	0.0000	0
righoup	0.0000	0.0000	0.0000	0
right	0.0000	0.0000	0.0000	1
rightury	0.0000	0.0000	0.0000	0
roo	0.0000	0.0000	0.0000	0
room	0.0000	0.0000	0.0000	0
roomba	0.0000	0.0000	0.0000	0
roombantor	0.0000	0.0000	0.0000	0
roombedroom	0.0000	0.0000	0.0000	0
roomm	0.0000	0.0000	0.0000	0
roomr	0.0000	0.0000	0.0000	0
roomroo	0.0000	0.0000	0.0000	0
rupboard	0.0000	0.0000	0.0000	0
shower	0.0000	0.0000	0.0000	2
shutt_r	0.0000	0.0000	0.0000	0
shutter	0.1205	0.1695	0.1408	59
stairs	0.0000	0.0000	0.0000	2
start_up	0.0000	0.0000	0.0000	0
stop	0.1915	0.0687	0.1011	131
sttar	0.0000	0.0000	0.0000	0
study	0.3486	0.7531	0.4766	81
supergdacyaramarket	0.0000	0.0000	0.0000	0
supergdarader	0.0000	0.0000	0.0000	0
supermarider	0.0000	0.0000	0.0000	0
supermarket	0.0000	0.0000	0.0000	0
t	0.0000	0.0000	0.0000	0
temperature	0.6667	0.1176	0.2000	17
tergeron-relatio	0.0000	0.0000	0.0000	0
true	0.0000	0.0000	0.0000	0
turn_down	0.0476	0.0566	0.0517	53
turn_off	0.5349	0.3844	0.4473	359
turn_on	0.6031	0.7697	0.6763	152
turn_up	0.2222	0.1667	0.1905	48
tv_matio	0.0000	0.0000	0.0000	0
tv_music_player	0.2095	0.2391	0.2234	92
tv_musicg_room	0.0000	0.0000	0.0000	0
volume	0.0000	0.0000	0.0000	2
vos	0.0000	0.0000	0.0000	0
vovure	0.0000	0.0000	0.0000	0
washing_macchen	0.0000	0.0000	0.0000	0
washing_machine	0.0000	0.0000	0.0000	0
washing_maching_	0.0000	0.0000	0.0000	0
wc	0.0000	0.0000	0.0000	75
wind	0.0000	0.0000	0.0000	0
window	0.2441	0.3444	0.2857	90
avg / total	0.5123	0.3881	0.4100	5243

Métriques pondérées

Slot-value Accuracy	0.2585
Slot-value Accuracy	per category
kettle	0.0069
stop	0.5224
1	0.0687
house	0.0476
turn_on	0.0000
lower	0.7697
0	0.3333
off	0.2806
off	0.0000

change	0.0000
on	0.0000
volume	0.0000
close	0.6875
kitchen	0.7478
bedroom	0.8793
open	0.6535
turn_down	0.0566
channel	0.0000
ceiling	0.0000
opened	0.0941
night_table	0.0000
closed	0.0000
door	0.1489
radio	0.2297
blind	0.6651
middle	0.0000
2	0.0000
wc	0.0000
study	0.7531
stairs	0.0000
right	0.0000
heating	0.0000
tv_music_player	0.2391
turn_up	0.1667
temperature	0.1176
bathroom	0.8916
window	0.3444
light	0.8276
living_room	0.8800
shutter	0.1695
fan	0.4143
shower	0.0000
raise	0.2530
turn_off	0.3844
curtain	0.0000

Slot-value	prec/recall/f1	precision	recall	f1-score	support
		0.0004	0.0069	0.0008	0.14431241451071627
0		0.9824	0.2806	0.4366	0.14431241451071394
1		0.5860	0.0476	0.0881	0.14431241451071508
2		0.0000	0.0000	0.0000	0.14431241451071455
_roomba		0.0000	0.0000	0.0000	0.0
a_l		0.0000	0.0000	0.0000	0.0
a_little		0.0000	0.0000	0.0000	0.0
a_lot		0.0000	0.0000	0.0000	0.0
amevabetle		0.0000	0.0000	0.0000	0.0
arahtor		0.0000	0.0000	0.0000	0.0
arantistudy		0.0000	0.0000	0.0000	0.0
artist		0.0000	0.0000	0.0000	0.0
artistname		0.0000	0.0000	0.0000	0.0
artisttare		0.0000	0.0000	0.0000	0.0
b		0.0000	0.0000	0.0000	0.0
bathroom		0.9740	0.8916	0.9310	0.1443124145107145
bed		0.0000	0.0000	0.0000	0.0
bedroo		0.0000	0.0000	0.0000	0.0
bedroom		0.9407	0.8793	0.9090	0.14431241451071425
blind		0.4313	0.6651	0.5233	0.1443124145107162
ceiling		0.0000	0.0000	0.0000	0.14431241451071455
change		0.0000	0.0000	0.0000	0.14431241451071458
channel		0.0000	0.0000	0.0000	0.14431241451071458
close		0.9309	0.6875	0.7909	0.14431241451071447
closed		0.0000	0.0000	0.0000	0.14431241451071455
clupe		0.0000	0.0000	0.0000	0.0
cod		0.0000	0.0000	0.0000	0.0
contact		0.0000	0.0000	0.0000	0.0

corridor	0.0000	0.0000	0.0000	0.0
corrim	0.0000	0.0000	0.0000	0.0
cup	0.0000	0.0000	0.0000	0.0
cupantom	0.0000	0.0000	0.0000	0.0
cupboard	0.0000	0.0000	0.0000	0.0
curtain	0.0000	0.0000	0.0000	0.14431241451071433
cy	0.0000	0.0000	0.0000	0.0
daugher	0.0000	0.0000	0.0000	0.0
daughter	0.0000	0.0000	0.0000	0.0
doctor	0.0000	0.0000	0.0000	0.0
door	0.6592	0.1489	0.2430	0.14431241451071442
drawer	0.0000	0.0000	0.0000	0.0
emergency	0.0000	0.0000	0.0000	0.0
fan	0.7404	0.4143	0.5313	0.14431241451071466
heating	0.0000	0.0000	0.0000	0.14431241451071455
hood	0.0000	0.0000	0.0000	0.0
house	0.0000	0.0000	0.0000	0.14431241451071455
kett_ume	0.0000	0.0000	0.0000	0.0
kettle	0.9613	0.5224	0.6769	0.14431241451071447
kitche	0.0000	0.0000	0.0000	0.0
kitchen	0.8849	0.7478	0.8106	0.1443124145107142
light	0.3140	0.8276	0.4552	0.1443124145107151
living_r	0.0000	0.0000	0.0000	0.0
living_room	0.6013	0.8800	0.7144	0.14431241451071455
low	0.0000	0.0000	0.0000	0.0
lower	0.4309	0.3333	0.3759	0.1443124145107152
middle	0.0000	0.0000	0.0000	0.14431241451071455
music_player	0.0000	0.0000	0.0000	0.0
night_table	0.0000	0.0000	0.0000	0.14431241451071458
off	0.0000	0.0000	0.0000	0.14431241451071458
on	0.0000	0.0000	0.0000	0.1443124145107146
onen	0.0000	0.0000	0.0000	0.0
ope	0.0000	0.0000	0.0000	0.0
open	0.3784	0.6535	0.4793	0.1443124145107143
opened	1.0000	0.0941	0.1720	0.14431241451071455
play	0.0000	0.0000	0.0000	0.0
play_stop	0.0000	0.0000	0.0000	0.0
raatim	0.0000	0.0000	0.0000	0.0
radio	0.5209	0.2297	0.3188	0.1443124145107146
rador	0.0000	0.0000	0.0000	0.0
raghce_	0.0000	0.0000	0.0000	0.0
raghce_m	0.0000	0.0000	0.0000	0.0
rain_	0.0000	0.0000	0.0000	0.0
raise	0.2063	0.2530	0.2273	0.1443124145107145
rasic_p	0.0000	0.0000	0.0000	0.0
ratise	0.0000	0.0000	0.0000	0.0
rest	0.0000	0.0000	0.0000	0.0
righoup	0.0000	0.0000	0.0000	0.0
right	0.0000	0.0000	0.0000	0.14431241451071455
rightury	0.0000	0.0000	0.0000	0.0
roo	0.0000	0.0000	0.0000	0.0
room	0.0000	0.0000	0.0000	0.0
roomba	0.0000	0.0000	0.0000	0.0
roombantor	0.0000	0.0000	0.0000	0.0
roombbedroom	0.0000	0.0000	0.0000	0.0
roomm	0.0000	0.0000	0.0000	0.0
roomr	0.0000	0.0000	0.0000	0.0
roomroo	0.0000	0.0000	0.0000	0.0
rupboard	0.0000	0.0000	0.0000	0.0
shower	0.0000	0.0000	0.0000	0.14431241451071455
shutt_r	0.0000	0.0000	0.0000	0.0
shutter	0.2167	0.1695	0.1902	0.14431241451071444
stairs	0.0000	0.0000	0.0000	0.14431241451071455
start_up	0.0000	0.0000	0.0000	0.0
stop	0.3117	0.0687	0.1126	0.14431241451071444
sttar	0.0000	0.0000	0.0000	0.0
study	0.7858	0.7531	0.7691	0.1443124145107145
supergdacyaramarket	0.0000	0.0000	0.0000	0.0

supergdarader	0.0000	0.0000	0.0000	0.0
supermarider	0.0000	0.0000	0.0000	0.0
supermarket	0.0000	0.0000	0.0000	0.0
t	0.0000	0.0000	0.0000	0.0
temperature	0.9885	0.1176	0.2103	0.1443124145107146
tergerson-relatio	0.0000	0.0000	0.0000	0.0
true	0.0000	0.0000	0.0000	0.0
turn_down	0.1675	0.0566	0.0846	0.14431241451071475
turn_off	0.1860	0.3844	0.2507	0.144312414510715
turn_on	0.5489	0.7697	0.6408	0.1443124145107147
turn_up	0.5743	0.1667	0.2584	0.14431241451071472
tv_matio	0.0000	0.0000	0.0000	0.0
tv_music_player	0.3801	0.2391	0.2936	0.1443124145107147
tv_musicg_room	0.0000	0.0000	0.0000	0.0
volume	0.0000	0.0000	0.0000	0.14431241451071455
vos	0.0000	0.0000	0.0000	0.0
vovure	0.0000	0.0000	0.0000	0.0
washing_macchen	0.0000	0.0000	0.0000	0.0
washing_machine	0.0000	0.0000	0.0000	0.0
washing_maching_	0.0000	0.0000	0.0000	0.0
wc	0.0000	0.0000	0.0000	0.14431241451071458
wind	0.0000	0.0000	0.0000	0.0
window	0.3639	0.3444	0.3539	0.14431241451071453
avg / total	0.3570	0.2585	0.2633	6.49405865298216

C.4 Appris et testé sur PORTMEDIA sans intention : mode mots

C.4.1 Slot-labels

Métriques non-pondérées

Slot-label Accuracy	0.6654
Slot-label Accuracy	per category
type-billet	0.7917
	0.0000
command-tache	0.9697
paiement-montant-entier	0.5000
objet	0.8140
objetbd	0.3636
reponse	0.9829
piece-nom-auteur	0.4839
nom-lieu	0.0000
lienref-codom	0.3333
temps-heure	0.7368
nb-billets	0.7234
nom-piece	0.6111
temps-annee	0.8824
connectattr	0.2500
connectprop	0.1000
nombre	0.2500
comparatif-temps	0.0000
rang	0.3750
nb-reservation	0.6667
lienref-elsens	0.0000
paiement-monnaie	0.5714
command-dial	0.8000
temps-date	0.8421
temps-jour-semaine	0.0000
lienref-coref	0.3750

Slot-label prec/recall/f1				
	precision	recall	f1-score	support

	0.0000	0.0000	0.0000	192
command-dial	0.8649	0.8000	0.8312	40
command-tache	0.9524	0.9697	0.9610	165
comparatif-temps	0.0000	0.0000	0.0000	1
connectattr	0.1429	0.2500	0.1818	8
connectprop	0.0500	0.1000	0.0667	10
etat-piece-complet	0.0000	0.0000	0.0000	0
lienref-codom	0.2500	0.3333	0.2857	6
lienref-coref	0.1875	0.3750	0.2500	8
lienref-elsens	0.0000	0.0000	0.0000	5
nb-billets	0.7556	0.7234	0.7391	47
nb-reservation	1.0000	0.6667	0.8000	3
nom-lieu	0.0000	0.0000	0.0000	2
nom-piece	0.7857	0.6111	0.6875	36
nombre	0.2000	0.2500	0.2222	12
objet	0.5000	0.8140	0.6195	43
objetbd	0.3636	0.3636	0.3636	22
paiement-monnaie	0.6667	0.5714	0.6154	14
paiement-montant-entier	0.5833	0.5000	0.5385	14
piece-nom-auteur	0.7895	0.4839	0.6000	31
rang	0.5000	0.3750	0.4286	8
reponse	0.9829	0.9829	0.9829	292
temps-annee	0.7895	0.8824	0.8333	17
temps-date	0.8889	0.8421	0.8649	38
temps-heure	0.6087	0.7368	0.6667	19
temps-jour-mois	0.0000	0.0000	0.0000	0
temps-jour-semaine	0.0000	0.0000	0.0000	1
type-billet	0.6786	0.7917	0.7308	24
avg / total	0.6646	0.6654	0.6609	1058

Métriques pondérées

Slot-label Accuracy 0.4778

Slot-label Accuracy per category
type-billet 0.7917

0.0000
command-tache 0.9697
paiement-montant-entier 0.5000
objet 0.8140
objetbd 0.3636
reponse 0.9829
piece-nom-auteur 0.4839
nom-lieu 0.0000
lienref-codom 0.3333
temps-heure 0.7368
nb-billets 0.7234
nom-piece 0.6111
temps-annee 0.8824
connectattr 0.2500
connectprop 0.1000
nombre 0.2500
comparatif-temps 0.0000
rang 0.3750
nb-reservation 0.6667
lienref-elsens 0.0000
paiement-monnaie 0.5714
command-dial 0.8000
temps-date 0.8421
temps-jour-semaine 0.0000
lienref-coref 0.3750

Slot-label prec/recall/f1

precision	recall	f1-score	support
0.0000	0.0000	0.0000	0.23417314813970727

command-dial	0.9685	0.8000	0.8762	0.23417314813970805
command-tache	0.9588	0.9697	0.9642	0.2341731481397087
comparatif-temps	0.0000	0.0000	0.0000	0.23417314813970813
connectattr	0.8000	0.2500	0.3810	0.2341731481397082
connectprop	0.5026	0.1000	0.1668	0.23417314813970808
etat-piece-complet	0.0000	0.0000	0.0000	0.0
lienref-codom	0.9143	0.3333	0.4885	0.2341731481397081
lienref-coref	0.8471	0.3750	0.5199	0.2341731481397082
lienref-elsens	0.0000	0.0000	0.0000	0.23417314813970813
nb-billets	0.9266	0.7234	0.8125	0.234173148139708
nb-reservation	1.0000	0.6667	0.8000	0.23417314813970813
nom-lieu	0.0000	0.0000	0.0000	0.23417314813970813
nom-piece	0.9514	0.6111	0.7442	0.23417314813970821
nombre	0.8000	0.2500	0.3810	0.23417314813970816
objet	0.8170	0.8140	0.8155	0.234173148139708
objetbd	0.8330	0.3636	0.5063	0.2341731481397081
paiement-monnaie	0.9648	0.5714	0.7178	0.23417314813970802
paiement-montant-entier	0.9505	0.5000	0.6553	0.23417314813970802
piece-nom-auteur	0.9587	0.4839	0.6431	0.2341731481397082
rang	0.9600	0.3750	0.5393	0.2341731481397082
reponse	0.9742	0.9829	0.9785	0.23417314813970627
temps-annee	0.9769	0.8824	0.9272	0.23417314813970821
temps-date	0.9759	0.8421	0.9041	0.23417314813970821
temps-heure	0.9402	0.7368	0.8262	0.23417314813970816
temps-jour-mois	0.0000	0.0000	0.0000	0.0
temps-jour-semaine	0.0000	0.0000	0.0000	0.23417314813970813
type-billet	0.9441	0.7917	0.8612	0.2341731481397082
avg / total	0.7294	0.4778	0.5580	6.088501851632408

C.4.2 Slot-values

Métriques non-pondérées

Slot-value Accuracy	0.5520
Slot-value Accuracy	per category
gardenia	0.0000
anna#viebrock	1.0000
nom-piece	0.0000
1	0.2500
4	0.2632
piece	0.5385
micro	0.1667
etat-piece-complet	0.0000
7	0.0000
2010	0.0000
oui	0.8824
info-salle	0.9648
temps-heure	0.0000
superieur	0.0000
info-acteur	0.0000
ecole#d' #art	0.0000
info-acces-mobred	0.0000
reservation	0.0000
25/07	0.9630
08/07	0.0000
entreelibre	0.0000
evenement	0.0000
non	0.2500
euro	0.9928
16h30	0.5714
philippe#menard	0.0000
la#mort#d' #adam	0.0000
38	0.5000
24/07	0.2500
	0.0000
	0.7500

07/07	0.0000
concert	0.0000
ecoles#au#festival	0.0000
10/07	0.1667
18/07	1.0000
26/07	0.0000
0	0.0000
joelle#gayot	1.0000
paiement-montant-entier	0.7000
miroirs#du#reel	0.0000
susan#sonntag	0.0000
info-auteur	0.0000
la#vingt#cinquieme#heure	0.0000
schutz#vor#der#zukunft	0.0000
implique	0.0000
ludovic#lagarde	0.0000
09h00	0.0000
explique	0.0000
18h00	0.5000
mathieu#bertholet	0.0000
deuxieme	0.0000
confirmation-demande	0.5000
chouf#ouchouf	0.0000
23/07	0.5000
20/07	0.5000
lectures#d'#ecrivains	0.0000
20h00	0.0000
13/07	0.0000
sujets#a#vif#programmation#b#black#monde	0.0000
annulation	0.5000
confirmation-annonce	0.7143
2	0.5000
22h00	0.6000
110550	0.0000
singulier	0.2632
19/07	0.6667
33	0.0000
info-acces-salle	0.0000
nb-billets	0.3333
gertrude#stein	0.0000
l'#homme#sans#qualites	0.0000
comment#ai#je#pu#tenir	0.0000
sujets#a#vif#programme#a	0.0000
tarifreduit	0.7500
info-placement	0.5000
12/07	1.0000
15h00	0.3333
troisieme	0.0000
23h00	0.0000
type-public	0.5000
information	0.8621
frederic#boyer	0.0000
frank#van#laecke	1.0000
13	0.0000
27	0.0000
14/07	0.0000
sasha#rau	0.0000
alain#platel	1.0000
theatre#des#idees	0.0000
la#vingt#cinquieme#heure#un#mage#en#ete	1.0000
pleintarif	0.4286
nicolas#truong	0.0000
baal	0.0000
julie#andree#t	0.3333
temps-date	0.7500
chapelle#des#penitents#blancs	0.0000
guy#cassiers	0.0000
pascal#dusapin	0.0000

jesaispas	0.0000
la#vingt#cinquieme#heure#dors#toi	0.0000
modification	0.5455
piece-nom-auteur	0.5000
premier	0.0000
3	0.5714
27/07	0.0000
repetition-demande	0.2000
la#tragedie#du#roi#richard#deux	0.0000
christoph#marthaler	0.0000
france#culture#en#public	0.2000
obtus#nixe	0.0000
not#waterproof	0.0000
olivier#cadiot	0.0000
jean#lambert#wild	0.2000
17/07	0.4000
rien	1.0000
21/07	0.0000
catherine#marnas	0.0000
16/07	0.0000
piece-resume	1.0000
16	0.5000
chloe#mons	0.0000
boris#charmatz	0.0000
17h00	0.5000
8	0.2500
addition	0.1538
6	0.1667
15/07	0.0000
restriction	0.0000
samedi	0.0000

Slot-value prec/recall/f1

	precision	recall	f1-score	support
	0.0000	0.0000	0.0000	192
0	0.0000	0.0000	0.0000	1
07/07	0.0000	0.0000	0.0000	1
08/07	0.0000	0.0000	0.0000	4
09h00	0.0000	0.0000	0.0000	1
1	0.4545	0.2632	0.3333	19
10	0.0000	0.0000	0.0000	0
10/07	0.5000	0.1667	0.2500	6
110550	0.0000	0.0000	0.0000	1
11h00	0.0000	0.0000	0.0000	0
12/07	0.1429	1.0000	0.2500	1
13	0.0000	0.0000	0.0000	1
13/07	0.0000	0.0000	0.0000	1
14/07	0.0000	0.0000	0.0000	1
15/07	0.0000	0.0000	0.0000	1
15h00	0.3333	0.3333	0.3333	3
16	0.5000	0.5000	0.5000	4
16/07	0.0000	0.0000	0.0000	1
16h30	0.0000	0.0000	0.0000	1
17/07	0.5000	0.4000	0.4444	5
17h00	0.2500	0.5000	0.3333	2
18/07	0.5000	1.0000	0.6667	1
18h00	0.2500	0.5000	0.3333	2
19/07	0.5000	0.6667	0.5714	3
2	0.4167	0.5000	0.4545	10
20/07	1.0000	0.5000	0.6667	2
2010	0.7895	0.8824	0.8333	17
20h00	0.0000	0.0000	0.0000	1
20h30	0.0000	0.0000	0.0000	0
21	0.0000	0.0000	0.0000	0
21/07	0.0000	0.0000	0.0000	1
22/07	0.0000	0.0000	0.0000	0
22h00	0.5000	0.6000	0.5455	5

23/07	0.5000	0.5000	0.5000	2
23h00	0.0000	0.0000	0.0000	4
24/07	1.0000	0.7500	0.8571	4
25/07	0.0000	0.0000	0.0000	1
26	0.0000	0.0000	0.0000	0
26/07	0.0000	0.0000	0.0000	2
27	0.0000	0.0000	0.0000	4
27/07	0.0000	0.0000	0.0000	1
3	0.3636	0.5714	0.4444	7
33	0.0000	0.0000	0.0000	1
38	0.0000	0.0000	0.0000	3
4	0.6364	0.5385	0.5833	13
5	0.0000	0.0000	0.0000	0
6	0.2500	0.1667	0.2000	6
7	0.0000	0.0000	0.0000	2
8	0.5000	0.2500	0.3333	4
94100	0.0000	0.0000	0.0000	0
addition	0.0714	0.1538	0.0976	13
alain#platel	0.5000	1.0000	0.6667	1
anna#viebrock	0.0000	0.0000	0.0000	2
annulation	0.3333	0.5000	0.4000	2
ariane#ascaride	0.0000	0.0000	0.0000	0
attente	0.0000	0.0000	0.0000	0
baal	0.0000	0.0000	0.0000	1
bal#du#quatorze#juillet	0.0000	0.0000	0.0000	0
boris#charmatz	0.0000	0.0000	0.0000	1
catherine#marnas	0.0000	0.0000	0.0000	2
chapelle#des#penitents#blancs	0.0000	0.0000	0.0000	1
chloe#mons	0.0000	0.0000	0.0000	2
chouf#ouchouf	0.0000	0.0000	0.0000	1
christoph#marthaler	0.0000	0.0000	0.0000	1
christophe#fiat	0.0000	0.0000	0.0000	0
comment#ai#je#pu#tenir	0.0000	0.0000	0.0000	1
concert	0.0000	0.0000	0.0000	1
confirmation-annonce	0.8333	0.7143	0.7692	21
confirmation-demande	0.2000	0.5000	0.2857	2
creation#deux#mille#dix	0.0000	0.0000	0.0000	0
deuxieme	0.0000	0.0000	0.0000	3
ecole#d'#art	0.0000	0.0000	0.0000	1
ecoles#au#festival	0.0000	0.0000	0.0000	1
entreelibre	0.0000	0.0000	0.0000	1
etat-piece-complet	0.0000	0.0000	0.0000	2
euro	0.6667	0.5714	0.6154	14
evenement	0.1250	0.2500	0.1667	4
explique	0.0000	0.0000	0.0000	1
flip#book	0.0000	0.0000	0.0000	0
france#culture#en#public	1.0000	0.2000	0.3333	5
francois#orsoni	0.0000	0.0000	0.0000	0
frank#van#laecke	1.0000	1.0000	1.0000	1
frederic#boyer	0.0000	0.0000	0.0000	1
gardenia	0.5000	1.0000	0.6667	1
gdra	0.0000	0.0000	0.0000	0
gertrude#stein	0.0000	0.0000	0.0000	1
guy#cassiers	0.0000	0.0000	0.0000	1
implique	0.0000	0.0000	0.0000	2
info-acces-mobred	0.0000	0.0000	0.0000	1
info-acces-salle	0.0000	0.0000	0.0000	1
info-acteur	0.0000	0.0000	0.0000	1
info-auteur	0.0000	0.0000	0.0000	1
info-placement	0.5000	0.5000	0.5000	2
info-salle	0.0000	0.0000	0.0000	2
info-tarif	0.0000	0.0000	0.0000	0
information	0.8621	0.8621	0.8621	29
jean#lambert#wild	1.0000	0.2000	0.3333	5
jesaispas	0.0000	0.0000	0.0000	3
joelle#gayot	1.0000	1.0000	1.0000	1
jonathan#capdevielle	0.0000	0.0000	0.0000	0
julie#andree#t	0.5000	0.3333	0.4000	3

l'#affaire#robinson	0.0000	0.0000	0.0000	0
l'#homme#sans#qualites	0.0000	0.0000	0.0000	2
la#mort#d'#adam	1.0000	0.2500	0.4000	4
la#tragedie#du#roi#richard#deux	0.0000	0.0000	0.0000	1
la#vingt#cinquieme#heure	0.0000	0.0000	0.0000	2
la#vingt#cinquieme#heure#adieu	0.0000	0.0000	0.0000	0
la#vingt#cinquieme#heure#dechiffage	0.0000	0.0000	0.0000	0
la#vingt#cinquieme#heure#dors#toi	0.0000	0.0000	0.0000	1
la#vingt#cinquieme#heure#un#mage#en#ete	1.0000	1.0000	1.0000	1
lectures#d'#ecrivains	0.0000	0.0000	0.0000	1
ludovic#lagarde	0.0000	0.0000	0.0000	1
mathieu#bertholet	0.0000	0.0000	0.0000	1
micro	0.0000	0.0000	0.0000	1
miroirs#du#reel	0.0000	0.0000	0.0000	2
modification	0.5455	0.5455	0.5455	11
nb-billets	0.1667	0.3333	0.2222	3
nicolas#truong	0.0000	0.0000	0.0000	1
nom-lieu	0.0000	0.0000	0.0000	0
nom-piece	0.3333	0.2500	0.2857	4
nombre	0.0000	0.0000	0.0000	0
non	0.9856	0.9928	0.9892	138
not#waterproof	0.0000	0.0000	0.0000	4
numero-referance	0.0000	0.0000	0.0000	0
obtus#nixe	0.0000	0.0000	0.0000	1
olivier#cadiot	0.0000	0.0000	0.0000	1
opposition	0.0000	0.0000	0.0000	0
oui	0.9648	0.9648	0.9648	142
paiement-montant-entier	0.3182	0.7000	0.4375	10
pascal#dusapin	0.0000	0.0000	0.0000	1
pascompris	0.0000	0.0000	0.0000	0
philippe#menard	0.5000	0.5000	0.5000	2
piece	0.2143	0.1667	0.1875	18
piece-nom-auteur	0.5000	0.5000	0.5000	4
piece-resume	0.3333	1.0000	0.5000	1
pierre#baux	0.0000	0.0000	0.0000	0
pleintarif	0.7500	0.4286	0.5455	7
pluriel	0.0000	0.0000	0.0000	0
pour#en#finir#avec#berenice	0.0000	0.0000	0.0000	0
premier	0.0000	0.0000	0.0000	4
repetition-demande	0.3333	0.2000	0.2500	5
reservation	0.9353	0.9630	0.9489	135
restriction	0.0000	0.0000	0.0000	2
rien	0.8182	1.0000	0.9000	9
rouge	0.0000	0.0000	0.0000	0
samedi	0.0000	0.0000	0.0000	1
sasha#rau	0.0000	0.0000	0.0000	1
schutz#vor#der#zukunft	0.0000	0.0000	0.0000	1
singulier	0.2083	0.2632	0.2326	19
sujets#a#vif#programmation#b#black#monde	0.0000	0.0000	0.0000	2
sujets#a#vif#programmation#c#proposition#d'#un#jour#d'#ete	0.0000	0.0000	0.0000	0
sujets#a#vif#programmation#d#laurent#sauvage#n'#est#pas#une#walkyrie	0.0000	0.0000	0.0000	0
sujets#a#vif#programme#a	0.0000	0.0000	0.0000	1
superieur	0.0000	0.0000	0.0000	1
susan#sonntag	0.0000	0.0000	0.0000	1
tarifreduit	0.5000	0.7500	0.6000	16
temps-date	0.4286	0.7500	0.5455	8
temps-heure	0.0000	0.0000	0.0000	1
theatre#des#idees	0.0000	0.0000	0.0000	1
troisieme	0.0000	0.0000	0.0000	1
type-public	1.0000	0.5000	0.6667	2
type-spectacle	0.0000	0.0000	0.0000	0
un#nid#pour#quoi#faire	0.0000	0.0000	0.0000	0
avg / total	0.5536	0.5520	0.5440	1058

Métriques pondérées

Slot-value Accuracy

0.2437

Slot-value Accuracy	per category
	0.0000
gardenia	1.0000
anna#viebrock	0.0000
nom-piece	0.2500
1	0.2632
4	0.5385
piece	0.1667
micro	0.0000
etat-piece-complet	0.0000
7	0.0000
2010	0.8824
oui	0.9648
info-salle	0.0000
temps-heure	0.0000
superieur	0.0000
info-acteur	0.0000
ecole#d'#art	0.0000
info-acces-mobred	0.0000
reservation	0.9630
25/07	0.0000
08/07	0.0000
entreelibre	0.0000
evenement	0.2500
non	0.9928
euro	0.5714
16h30	0.0000
philippe#menard	0.5000
la#mort#d'#adam	0.2500
38	0.0000
24/07	0.7500
07/07	0.0000
concert	0.0000
ecoles#au#festival	0.0000
10/07	0.1667
18/07	1.0000
26/07	0.0000
0	0.0000
joelle#gayot	1.0000
paiement-montant-entier	0.7000
miroirs#du#reel	0.0000
susan#sontag	0.0000
info-auteur	0.0000
la#vingt#cinquieme#heure	0.0000
schutz#vor#der#zukunft	0.0000
implique	0.0000
ludovic#lagarde	0.0000
09h00	0.0000
explique	0.0000
18h00	0.5000
mathieu#bertholet	0.0000
deuxieme	0.0000
confirmation-demande	0.5000
chouf#ouchouf	0.0000
23/07	0.5000
20/07	0.5000
lectures#d'#ecrivains	0.0000
20h00	0.0000
13/07	0.0000
sujets#a#vif#programmation#b#black#monde	0.0000
annulation	0.5000
confirmation-annonce	0.7143
2	0.5000
22h00	0.6000
110550	0.0000
singulier	0.2632
19/07	0.6667

33	0.0000
info-acces-salle	0.0000
nb-billets	0.3333
gertrude#stein	0.0000
l'#homme#sans#qualites	0.0000
comment#ai#je#pu#tenir	0.0000
sujets#a#vif#programme#a	0.0000
tarifreduit	0.7500
info-placement	0.5000
12/07	1.0000
15h00	0.3333
troisieme	0.0000
23h00	0.0000
type-public	0.5000
information	0.8621
frederic#boyer	0.0000
frank#van#laecke	1.0000
13	0.0000
27	0.0000
14/07	0.0000
sasha#rau	0.0000
alain#platel	1.0000
theatre#des#idees	0.0000
la#vingt#cinquieme#heure#un#mage#en#ete	1.0000
pleintarif	0.4286
nicolas#truong	0.0000
baal	0.0000
julie#andree#t	0.3333
temps-date	0.7500
chapelle#des#penitents#blancs	0.0000
guy#cassiers	0.0000
pascal#dusapin	0.0000
jesaispas	0.0000
la#vingt#cinquieme#heure#dors#toi	0.0000
modification	0.5455
piece-nom-auteur	0.5000
premier	0.0000
3	0.5714
27/07	0.0000
repetition-demande	0.2000
la#tragedie#du#roi#richard#deux	0.0000
christoph#marthaler	0.0000
france#culture#en#public	0.2000
obtus#nixe	0.0000
not#waterproof	0.0000
olivier#cadiot	0.0000
jean#lambert#wild	0.2000
17/07	0.4000
rien	1.0000
21/07	0.0000
catherine#marnas	0.0000
16/07	0.0000
piece-resume	1.0000
16	0.5000
chloe#mons	0.0000
boris#charmatz	0.0000
17h00	0.5000
8	0.2500
addition	0.1538
6	0.1667
15/07	0.0000
restriction	0.0000
samedi	0.0000

Slot-value prec/recall/f1

	precision	recall	f1-score	support
	0.0000	0.0000	0.0000	0.012642

ANNEXE C. RÉSULTATS DE L'ÉVALUATION POUR TF-SEQ2SEQ

0	0.0000	0.0000	0.0000	0.012642
07/07	0.0000	0.0000	0.0000	0.012642
08/07	0.0000	0.0000	0.0000	0.012642
09h00	0.0000	0.0000	0.0000	0.012642
1	0.8939	0.2632	0.4066	0.012642
10	0.0000	0.0000	0.0000	0.0
10/07	0.9697	0.1667	0.2844	0.012642
110550	0.0000	0.0000	0.0000	0.012642
11h00	0.0000	0.0000	0.0000	0.0
12/07	0.2182	1.0000	0.3582	0.012642
13	0.0000	0.0000	0.0000	0.012642
13/07	0.0000	0.0000	0.0000	0.012642
14/07	0.0000	0.0000	0.0000	0.012642
15/07	0.0000	0.0000	0.0000	0.012642
15h00	0.4000	0.3333	0.3636	0.012642
16	0.3322	0.5000	0.3992	0.012642
16/07	0.0000	0.0000	0.0000	0.012642
16h30	0.0000	0.0000	0.0000	0.012642
17/07	0.3243	0.4000	0.3582	0.012642
17h00	0.7038	0.5000	0.5847	0.012642
18/07	0.8000	1.0000	0.8889	0.012642
18h00	0.5234	0.5000	0.5115	0.012642
19/07	0.3478	0.6667	0.4571	0.012642
2	0.6120	0.5000	0.5503	0.012642
20/07	1.0000	0.5000	0.6667	0.012642
2010	0.9769	0.8824	0.9272	0.012642
20h00	0.0000	0.0000	0.0000	0.012642
20h30	0.0000	0.0000	0.0000	0.0
21	0.0000	0.0000	0.0000	0.0
21/07	0.0000	0.0000	0.0000	0.012642
22/07	0.0000	0.0000	0.0000	0.0
22h00	0.6358	0.6000	0.6174	0.012642
23/07	0.3333	0.5000	0.4000	0.012642
23h00	0.0000	0.0000	0.0000	0.012642
24/07	1.0000	0.7500	0.8571	0.012642
25/07	0.0000	0.0000	0.0000	0.012642
26	0.0000	0.0000	0.0000	0.0
26/07	0.0000	0.0000	0.0000	0.012642
27	0.0000	0.0000	0.0000	0.012642
27/07	0.0000	0.0000	0.0000	0.012642
3	0.5178	0.5714	0.5433	0.012642
33	0.0000	0.0000	0.0000	0.012642
38	0.0000	0.0000	0.0000	0.012642
4	0.2635	0.5385	0.3538	0.012642
5	0.0000	0.0000	0.0000	0.0
6	0.9143	0.1667	0.2819	0.012642
7	0.0000	0.0000	0.0000	0.012642
8	0.5000	0.2500	0.3333	0.012642
94100	0.0000	0.0000	0.0000	0.0
addition	0.1962	0.1538	0.1725	0.012642
alain#platel	0.9948	1.0000	0.9974	0.012642
anna#viebrock	0.0000	0.0000	0.0000	0.012642
annulation	0.8388	0.5000	0.6265	0.012642
ariane#ascaride	0.0000	0.0000	0.0000	0.0
attente	0.0000	0.0000	0.0000	0.0
baal	0.0000	0.0000	0.0000	0.012642
bal#du#quatorze#juillet	0.0000	0.0000	0.0000	0.0
boris#charmatz	0.0000	0.0000	0.0000	0.012642
catherine#marnas	0.0000	0.0000	0.0000	0.012642
chappelle#des#penitents#blancs	0.0000	0.0000	0.0000	0.012642
chloe#mons	0.0000	0.0000	0.0000	0.012642
chouf#ouchouf	0.0000	0.0000	0.0000	0.012642
christoph#marthaler	0.0000	0.0000	0.0000	0.012642
christophe#fiat	0.0000	0.0000	0.0000	0.0
comment#ai#je#pu#tenir	0.0000	0.0000	0.0000	0.012642
concert	0.0000	0.0000	0.0000	0.012642
confirmation-annonce	0.9786	0.7143	0.8258	0.012642
confirmation-demande	0.5642	0.5000	0.5302	0.012642

creation#deux#mille#dix	0.0000	0.0000	0.0000	0.0
deuxieme	0.0000	0.0000	0.0000	0.012642
ecole#d'#art	0.0000	0.0000	0.0000	0.012642
ecoles#au#festival	0.0000	0.0000	0.0000	0.012642
entreelibre	0.0000	0.0000	0.0000	0.012642
etat-piece-complet	0.0000	0.0000	0.0000	0.012642
euro	0.9648	0.5714	0.7178	0.012642
evenement	0.5714	0.2500	0.3478	0.012642
explique	0.0000	0.0000	0.0000	0.012642
flip#book	0.0000	0.0000	0.0000	0.0
france#culture#en#public	1.0000	0.2000	0.3333	0.012642
francois#orsoni	0.0000	0.0000	0.0000	0.0
frank#van#laecke	1.0000	1.0000	1.0000	0.012642
frederic#boyer	0.0000	0.0000	0.0000	0.012642
gardenia	0.9948	1.0000	0.9974	0.012642
gdra	0.0000	0.0000	0.0000	0.0
gertrude#stein	0.0000	0.0000	0.0000	0.012642
guy#cassiers	0.0000	0.0000	0.0000	0.012642
implique	0.0000	0.0000	0.0000	0.012642
info-acces-mobred	0.0000	0.0000	0.0000	0.012642
info-acces-salle	0.0000	0.0000	0.0000	0.012642
info-acteur	0.0000	0.0000	0.0000	0.012642
info-auteur	0.0000	0.0000	0.0000	0.012642
info-placement	0.9897	0.5000	0.6644	0.012642
info-salle	0.0000	0.0000	0.0000	0.012642
info-tarif	0.0000	0.0000	0.0000	0.0
information	0.8778	0.8621	0.8699	0.012642
jean#lambert#wild	1.0000	0.2000	0.3333	0.012642
jesaispas	0.0000	0.0000	0.0000	0.012642
joelle#gayot	1.0000	1.0000	1.0000	0.012642
jonathan#capdevielle	0.0000	0.0000	0.0000	0.0
julie#andree#t	0.4000	0.3333	0.3636	0.012642
l'#affaire#robinson	0.0000	0.0000	0.0000	0.0
l'#homme#sans#qualites	0.0000	0.0000	0.0000	0.012642
la#mort#d'#adam	1.0000	0.2500	0.4000	0.012642
la#tragedie#du#roi#richard#deux	0.0000	0.0000	0.0000	0.012642
la#vingt#cinquieme#heure	0.0000	0.0000	0.0000	0.012642
la#vingt#cinquieme#heure#adieu	0.0000	0.0000	0.0000	0.0
la#vingt#cinquieme#heure#dechiffage	0.0000	0.0000	0.0000	0.0
la#vingt#cinquieme#heure#dors#toi	0.0000	0.0000	0.0000	0.012642
la#vingt#cinquieme#heure#un#mage#en#ete	1.0000	1.0000	1.0000	0.012642
lectures#d'#ecrivains	0.0000	0.0000	0.0000	0.012642
ludovic#lagarde	0.0000	0.0000	0.0000	0.012642
mathieu#bertholet	0.0000	0.0000	0.0000	0.012642
micro	0.0000	0.0000	0.0000	0.012642
miroirs#du#reel	0.0000	0.0000	0.0000	0.012642
modification	0.6409	0.5455	0.5893	0.012642
nb-billets	0.5517	0.3333	0.4156	0.012642
nicolas#truong	0.0000	0.0000	0.0000	0.012642
nom-lieu	0.0000	0.0000	0.0000	0.0
nom-piece	0.4248	0.2500	0.3148	0.012642
nombre	0.0000	0.0000	0.0000	0.0
non	0.9878	0.9928	0.9903	0.012642
not#waterproof	0.0000	0.0000	0.0000	0.012642
numero-reference	0.0000	0.0000	0.0000	0.0
obtus#nixe	0.0000	0.0000	0.0000	0.012642
olivier#cadiot	0.0000	0.0000	0.0000	0.012642
opposition	0.0000	0.0000	0.0000	0.0
oui	0.7315	0.9648	0.8321	0.012642
paiement-montant-entier	0.2324	0.7000	0.3489	0.012642
pascal#dusapin	0.0000	0.0000	0.0000	0.012642
pascompris	0.0000	0.0000	0.0000	0.0
philippe#menard	0.9897	0.5000	0.6644	0.012642
piece	0.3556	0.1667	0.2270	0.012642
piece-nom-auteur	0.9796	0.5000	0.6621	0.012642
piece-resume	0.9897	1.0000	0.9948	0.012642
pierre#baux	0.0000	0.0000	0.0000	0.0
pleintarif	0.3000	0.4286	0.3529	0.012642

pluriel	0.0000	0.0000	0.0000	0.0
pour#en#finir#avec#berenice	0.0000	0.0000	0.0000	0.0
premier	0.0000	0.0000	0.0000	0.012642
repetition-demande	0.9505	0.2000	0.3305	0.012642
reservation	0.8344	0.9630	0.8941	0.012642
restriction	0.0000	0.0000	0.0000	0.012642
rien	0.7471	1.0000	0.8552	0.012642
rouge	0.0000	0.0000	0.0000	0.0
samedi	0.0000	0.0000	0.0000	0.012642
sasha#rau	0.0000	0.0000	0.0000	0.012642
schutz#vor#der#zukunft	0.0000	0.0000	0.0000	0.012642
singulier	0.7267	0.2632	0.3864	0.012642
sujets#a#vif#programmation#b#black#monde	0.0000	0.0000	0.0000	0.012642
sujets#a#vif#programmation#c#proposition#d'#un#jour#d'#ete	0.0000	0.0000	0.0000	0.0
sujets#a#vif#programmation#d#laurent#sauvage#n'#est#pas#une#walkyrie	0.0000	0.0000	0.0000	0.0
sujets#a#vif#programme#a	0.0000	0.0000	0.0000	0.012642
superieur	0.0000	0.0000	0.0000	0.012642
susan#sontag	0.0000	0.0000	0.0000	0.012642
tarifreduit	0.6120	0.7500	0.6740	0.012642
temps-date	0.4034	0.7500	0.5246	0.012642
temps-heure	0.0000	0.0000	0.0000	0.012642
theatre#des#idees	0.0000	0.0000	0.0000	0.012642
troisieme	0.0000	0.0000	0.0000	0.012642
type-public	1.0000	0.5000	0.6667	0.012642
type-spectacle	0.0000	0.0000	0.0000	0.0
un#nid#pour#quoi#faire	0.0000	0.0000	0.0000	0.0
avg / total	0.3031	0.2437	0.2484	1.63093312626

C.5 Appris et testé sur PORTMEDIA sans intention : mode caractères

C.5.1 Slot-labels

Métriques non-pondérées

Slot-label Accuracy	0.6228
Slot-label Accuracy	per category
lienref-codom	0.0000
objetbd	0.3333
temps-annee	0.2273
temps-heure	0.8235
type-billet	0.7368
connectattr	0.5417
connectattr	0.1250
lienref-coref	0.2500
nb-billets	0.2500
command-tache	0.5319
command-tache	0.9515
paiement-monnaie	0.0714
lienref-elsens	0.0000
objet	0.5581
reponse	0.5581
nombre	0.9658
command-dial	0.2500
temps-jour-semaine	0.8250
temps-jour-semaine	0.0000
piece-nom-auteur	0.0000
nom-piece	0.2903
nom-piece	0.6389
nom-lieu	0.0000
temps-date	0.0000
temps-date	0.7105
nb-reservation	0.0000
paiement-montant-entier	0.0000
paiement-montant-entier	0.0714
connectprop	0.3000
rang	0.0000
rang	0.0000
comparatif-temps	0.0000

Slot-label	prec/recall/f1	precision	recall	f1-score	support
		0.0000	0.0000	0.0000	160
command-dial		0.8049	0.8250	0.8148	40
command-tache		0.9345	0.9515	0.9429	165
comparatif-temps		0.0000	0.0000	0.0000	1
connectattr		0.5000	0.1250	0.2000	8
connectprop		0.4286	0.3000	0.3529	10
lienref		0.0000	0.0000	0.0000	0
lienref-codom		0.2857	0.3333	0.3077	6
lienref-coref		0.2857	0.2500	0.2667	8
lienref-elsens		0.0000	0.0000	0.0000	5
nb-bille		0.0000	0.0000	0.0000	0
nb-billets		0.6579	0.5319	0.5882	47
nb-reservation		0.0000	0.0000	0.0000	3
nom-lieu		0.0000	0.0000	0.0000	2
nom-piece		0.6765	0.6389	0.6571	36
nombre		0.2000	0.2500	0.2222	12
o		0.0000	0.0000	0.0000	0
ob		0.0000	0.0000	0.0000	0
objet		0.5000	0.5581	0.5275	43
objetb		0.0000	0.0000	0.0000	0
objetbd		0.2778	0.2273	0.2500	22
pa		0.0000	0.0000	0.0000	0
paiemen		0.0000	0.0000	0.0000	0
paiement-monnaie		0.5000	0.0714	0.1250	14
paiement-montant-entier		0.3333	0.0714	0.1176	14
piece		0.0000	0.0000	0.0000	0
piece-nom-aut		0.0000	0.0000	0.0000	0
piece-nom-auteur		0.6000	0.2903	0.3913	31
rang		0.0000	0.0000	0.0000	8
reponse		0.9792	0.9658	0.9724	292
temp		0.0000	0.0000	0.0000	0
temps		0.0000	0.0000	0.0000	0
temps-annee		0.7000	0.8235	0.7568	17
temps-date		0.8438	0.7105	0.7714	38
temps-heure		0.7778	0.7368	0.7568	19
temps-jour-mois		0.0000	0.0000	0.0000	0
temps-jour-semaine		0.0000	0.0000	0.0000	1
type-billet		0.7647	0.5417	0.6341	24
avg / total		0.6601	0.6228	0.6342	1026

Métriques pondérées

Slot-label Accuracy	0.3539
Slot-label Accuracy	per category
	0.0000
lienref-codom	0.3333
objetbd	0.2273
temps-annee	0.8235
temps-heure	0.7368
type-billet	0.5417
connectattr	0.1250
lienref-coref	0.2500
nb-billets	0.5319
command-tache	0.9515
paiement-monnaie	0.0714
lienref-elsens	0.0000
objet	0.5581
reponse	0.9658
nombre	0.2500
command-dial	0.8250
temps-jour-semaine	0.0000
piece-nom-auteur	0.2903

nom-piece	0.6389
nom-lieu	0.0000
temps-date	0.7105
nb-reservation	0.0000
paiement-montant-entier	0.0714
connectprop	0.3000
rang	0.0000
comparatif-temps	0.0000

Slot-label	prec/recall/f1	precision	recall	f1-score	support
		0.0000	0.0000	0.0000	0.23411604012913778
command-dial		0.9429	0.8250	0.8800	0.2341160401291384
command-tache		0.9326	0.9515	0.9420	0.23411604012913814
comparatif-temps		0.0000	0.0000	0.0000	0.23411604012913828
connectattr		0.9524	0.1250	0.2210	0.23411604012913825
connectprop		0.9231	0.3000	0.4528	0.23411604012913823
lienref		0.0000	0.0000	0.0000	0.0
lienref-codom		0.9143	0.3333	0.4885	0.23411604012913828
lienref-coref		0.8889	0.2500	0.3902	0.23411604012913825
lienref-elsens		0.0000	0.0000	0.0000	0.23411604012913825
nb-bille		0.0000	0.0000	0.0000	0.0
nb-billets		0.8675	0.5319	0.6595	0.23411604012913817
nb-reservation		0.0000	0.0000	0.0000	0.23411604012913828
nom-lieu		0.0000	0.0000	0.0000	0.23411604012913828
nom-piece		0.9028	0.6389	0.7483	0.23411604012913806
nombre		0.7692	0.2500	0.3774	0.23411604012913834
o		0.0000	0.0000	0.0000	0.0
ob		0.0000	0.0000	0.0000	0.0
objet		0.7882	0.5581	0.6535	0.2341160401291384
objetb		0.0000	0.0000	0.0000	0.0
objetbd		0.7366	0.2273	0.3474	0.23411604012913817
pa		0.0000	0.0000	0.0000	0.0
paieren		0.0000	0.0000	0.0000	0.0
paiement-monnaie		0.9195	0.0714	0.1326	0.2341160401291383
paiement-montant-entier		0.8511	0.0714	0.1318	0.2341160401291383
piece		0.0000	0.0000	0.0000	0.0
piece-nom-aut		0.0000	0.0000	0.0000	0.0
piece-nom-auteur		0.8856	0.2903	0.4373	0.2341160401291383
rang		0.0000	0.0000	0.0000	0.23411604012913825
reponse		0.9626	0.9658	0.9642	0.234116040129139
temp		0.0000	0.0000	0.0000	0.0
temps		0.0000	0.0000	0.0000	0.0
temps-annee		0.9564	0.8235	0.8850	0.23411604012913828
temps-date		0.9579	0.7105	0.8159	0.23411604012913814
temps-heure		0.9672	0.7368	0.8364	0.2341160401291382
temps-jour-mois		0.0000	0.0000	0.0000	0.0
temps-jour-semaine		0.0000	0.0000	0.0000	0.23411604012913828
type-billet		0.9559	0.5417	0.6915	0.2341160401291384
avg / total		0.6567	0.3539	0.4252	6.087017043357595

C.5.2 Slot-values

Métriques non-pondérées

Slot-value Accuracy	0.5273
Slot-value Accuracy	per category
	0.0211
temps-date	0.3750
2	0.1000
sujets#a#vif#programmation#b#black#monde	0.0000
27/07	0.0000
annulation	0.5000
pascal#dusapin	0.0000

C.5. APPRIS ET TESTÉ SUR PORTMEDIA SANS INTENTION: MODE CARACTÈRES 67

09h00	0.0000
15h00	0.0000
christoph#marthaler	0.0000
08/07	0.2500
frank#van#laecke	0.0000
not#waterproof	0.0000
france#culture#en#public	0.4000
gertrude#stein	0.0000
susan#sontag	0.0000
singulier	0.2105
3	0.1429
micro	0.0000
25/07	0.0000
22h00	0.4000
deuxieme	0.0000
miroirs#du#reel	0.0000
tarifreduit	0.3125
1	0.3684
110550	0.0000
julie#andree#t	0.3333
15/07	1.0000
nom-piece	0.0000
baal	0.0000
joelle#gayot	0.0000
comment#ai#je#pu#tenir	0.0000
info-salle	0.5000
philippe#menard	0.0000
jesaispas	0.0000
info-acces-salle	0.0000
troisieme	0.0000
nicolas#truong	0.0000
10/07	0.0000
8	0.0000
19/07	0.3333
frederic#boyer	0.0000
info-placement	0.0000
samedi	0.0000
concert	0.0000
non	0.9783
rien	1.0000
la#vingt#cinquieme#heure#dors#toi	0.0000
ludovic#lagarde	0.0000
23h00	0.2500
mathieu#bertholet	0.0000
24/07	0.0000
piece-resume	0.0000
gardenia	0.0000
16	0.0000
13	0.0000
addition	0.1538
la#vingt#cinquieme#heure#un#mage#en#ete	0.0000
repetition-demande	0.6000
information	0.9655
catherine#marnas	0.0000
premier	0.0000
7	0.0000
info-acteur	0.0000
27	0.0000
07/07	0.0000
la#mort#d'#adam	0.2500
obtus#nixe	0.0000
anna#viebrock	0.0000
euro	0.0714
restriction	0.5000
18/07	0.0000
temps-heure	0.0000
6	0.0000
12/07	1.0000

explique	0.0000
23/07	0.5000
type-public	0.0000
nb-billets	0.3333
21/07	0.0000
evenement	0.0000
26/07	0.0000
sasha#rau	0.0000
piece	0.0556
superieur	0.0000
oui	0.9366
info-acces-mobred	0.0000
theatre#des#idees	0.0000
2010	0.8235
confirmation-demande	0.0000
14/07	0.0000
chouf#ouchouf	0.0000
pleintarif	0.5714
entreelibre	0.0000
17h00	0.5000
ecoles#au#festival	0.0000
la#tragedie#du#roi#richard#deux	0.0000
schutz#vor#der#zukunft	0.0000
18h00	0.5000
reservation	0.9407
implique	0.0000
l'#homme#sans#qualites	0.0000
4	0.0833
chloe#mons	0.0000
sujets#a#vif#programme#a	0.0000
0	0.0000
modification	0.7273
16/07	0.0000
38	0.0000
16h30	0.0000
info-auteur	0.0000
20/07	0.5000
20h00	0.0000
chapelle#des#penitents#blancs	0.0000
13/07	0.0000
la#vingt#cinquieme#heure	0.5000
lectures#d'#ecrivains	0.0000
guy#cassiers	0.0000
confirmation-annonce	0.8571
piece-nom-auteur	0.0000
boris#charmatz	0.0000
etat-piece-complet	0.0000
paiement-montant-entier	0.3000
17/07	0.0000
33	0.0000
olivier#cadiot	0.0000
jean#lambert#wild	0.0000
ecole#d'#art	0.0000
alain#platel	0.0000

Slot-value prec/recall/f1

	precision	recall	f1-score	support
	0.0130	0.0211	0.0161	142
0	0.0000	0.0000	0.0000	1
07/07	0.0000	0.0000	0.0000	1
08/07	0.2500	0.2500	0.2500	4
09h00	0.0000	0.0000	0.0000	1
1	0.3182	0.3684	0.3415	19
10/07	0.0000	0.0000	0.0000	6
1010	0.0000	0.0000	0.0000	0
11/07	0.0000	0.0000	0.0000	0
110550	0.0000	0.0000	0.0000	1

C.5. APPRIS ET TESTÉ SUR PORTMEDIA SANS INTENTION: MODE CARACTÈRES 69

11h00	0.0000	0.0000	0.0000	0
12/07	0.5000	1.0000	0.6667	1
13	0.0000	0.0000	0.0000	1
13/07	0.0000	0.0000	0.0000	1
14/07	0.0000	0.0000	0.0000	1
15/07	0.5000	1.0000	0.6667	1
15h00	0.0000	0.0000	0.0000	3
16	0.0000	0.0000	0.0000	4
16/07	0.0000	0.0000	0.0000	1
16h30	0.0000	0.0000	0.0000	1
17	0.0000	0.0000	0.0000	0
17/07	0.0000	0.0000	0.0000	5
17h00	1.0000	0.5000	0.6667	2
18/07	0.0000	0.0000	0.0000	1
18h00	0.3333	0.5000	0.4000	2
19/07	0.3333	0.3333	0.3333	3
2	0.1429	0.1000	0.1176	10
20	0.0000	0.0000	0.0000	0
20/07	0.5000	0.5000	0.5000	2
2010	0.7778	0.8235	0.8000	17
20h00	0.0000	0.0000	0.0000	1
21	0.0000	0.0000	0.0000	0
21/07	0.0000	0.0000	0.0000	1
21h00	0.0000	0.0000	0.0000	0
22/07	0.0000	0.0000	0.0000	0
22h00	0.5000	0.4000	0.4444	5
23/07	0.2500	0.5000	0.3333	2
23h00	1.0000	0.2500	0.4000	4
24/07	0.0000	0.0000	0.0000	4
25/07	0.0000	0.0000	0.0000	1
26/07	0.0000	0.0000	0.0000	2
27	0.0000	0.0000	0.0000	4
27/07	0.0000	0.0000	0.0000	1
3	0.1429	0.1429	0.1429	7
33	0.0000	0.0000	0.0000	1
38	0.0000	0.0000	0.0000	3
4	0.1667	0.0833	0.1111	12
5	0.0000	0.0000	0.0000	0
6	0.0000	0.0000	0.0000	6
7	0.0000	0.0000	0.0000	2
8	0.0000	0.0000	0.0000	4
addition	0.5000	0.1538	0.2353	13
alain#platel	0.0000	0.0000	0.0000	1
anna#viebrock	0.0000	0.0000	0.0000	2
annulation	0.2500	0.5000	0.3333	2
antoinat	0.0000	0.0000	0.0000	0
baal	0.0000	0.0000	0.0000	1
bal#du#beran	0.0000	0.0000	0.0000	0
boris#charmatz	0.0000	0.0000	0.0000	1
catherine#marnas	0.0000	0.0000	0.0000	2
chapelle#des#penitents#blancs	0.0000	0.0000	0.0000	1
checres#adine	0.0000	0.0000	0.0000	0
chloe#mons	0.0000	0.0000	0.0000	2
chlottre#mar	0.0000	0.0000	0.0000	0
chouf#ouchouf	0.0000	0.0000	0.0000	1
christoph#marthaler	0.0000	0.0000	0.0000	1
comment#ai#je#pu#tenir	0.0000	0.0000	0.0000	1
concert	0.0000	0.0000	0.0000	1
confirmation-annonce	0.8182	0.8571	0.8372	21
confirmation-demande	0.0000	0.0000	0.0000	2
deuxieme	0.0000	0.0000	0.0000	3
ecole#d'#art	0.0000	0.0000	0.0000	1
ecoles#au#festival	0.0000	0.0000	0.0000	1
entreelibre	0.0000	0.0000	0.0000	1
etat-piece-complet	0.0000	0.0000	0.0000	2
euro	0.5000	0.0714	0.1250	14
evenement	0.0000	0.0000	0.0000	4
expli	0.0000	0.0000	0.0000	0

explique	0.0000	0.0000	0.0000	1
fhliviengarel	0.0000	0.0000	0.0000	0
fhris#truogragel	0.0000	0.0000	0.0000	0
flip#book	0.0000	0.0000	0.0000	0
france#culture#en#public	0.2857	0.4000	0.3333	5
frank#van#laecke	0.0000	0.0000	0.0000	1
franxack	0.0000	0.0000	0.0000	0
frederic#boyer	0.0000	0.0000	0.0000	1
gardenia	0.0000	0.0000	0.0000	1
gertrude#stein	0.0000	0.0000	0.0000	1
guy#cassiers	0.0000	0.0000	0.0000	1
impli	0.0000	0.0000	0.0000	0
implique	0.0000	0.0000	0.0000	2
info-acces-mobred	0.0000	0.0000	0.0000	1
info-acces-salle	0.0000	0.0000	0.0000	1
info-acteur	0.0000	0.0000	0.0000	1
info-auteur	0.0000	0.0000	0.0000	1
info-placement	0.0000	0.0000	0.0000	2
info-salle	0.2500	0.5000	0.3333	2
information	0.8000	0.9655	0.8750	29
jean	0.0000	0.0000	0.0000	0
jean#lamber#tion	0.0000	0.0000	0.0000	0
jean#lambert#wild	0.0000	0.0000	0.0000	5
jean#rietopoe	0.0000	0.0000	0.0000	0
jesaispas	0.0000	0.0000	0.0000	3
joelle#gayot	0.0000	0.0000	0.0000	1
julie	0.0000	0.0000	0.0000	0
julie#andree#t	1.0000	0.3333	0.5000	3
l'#afconge#robenta	0.0000	0.0000	0.0000	0
l'#homme#sans#qualites	0.0000	0.0000	0.0000	2
l'#orchestre#perdu	0.0000	0.0000	0.0000	0
la#contre#saut	0.0000	0.0000	0.0000	0
la#contre#sesuse#tesine	0.0000	0.0000	0.0000	0
la#mort#d'#adam	1.0000	0.2500	0.4000	4
la#tragedie#du#roi#richard#deux	0.0000	0.0000	0.0000	1
la#vingt#cinquiem	0.0000	0.0000	0.0000	0
la#vingt#cinquieme#heure	0.2500	0.5000	0.3333	2
la#vingt#cinquieme#heure#derzer	0.0000	0.0000	0.0000	0
la#vingt#cinquieme#heure#deure	0.0000	0.0000	0.0000	0
la#vingt#cinquieme#heure#dors#toi	0.0000	0.0000	0.0000	1
la#vingt#cinquieme#heure#echif#	0.0000	0.0000	0.0000	0
la#vingt#cinquieme#heure#en#atere#entaer	0.0000	0.0000	0.0000	0
la#vingt#cinquieme#heure#en#emen#eine	0.0000	0.0000	0.0000	0
la#vingt#cinquieme#heure#en#en#en#ete	0.0000	0.0000	0.0000	0
la#vingt#cinquieme#heure#en#pub	0.0000	0.0000	0.0000	0
la#vingt#cinquieme#heure#en#public	0.0000	0.0000	0.0000	0
la#vingt#cinquieme#heure#un#mage#en#ete	0.0000	0.0000	0.0000	1
lectures#d'#ecrivains	0.0000	0.0000	0.0000	1
ludovic#lagarde	0.0000	0.0000	0.0000	1
mathieu#bertholet	0.0000	0.0000	0.0000	1
micro	0.0000	0.0000	0.0000	1
miroirs#du#reel	0.0000	0.0000	0.0000	2
modification	0.6667	0.7273	0.6957	11
nb-billets	0.3333	0.3333	0.3333	3
nicolas#truong	0.0000	0.0000	0.0000	1
nom-liec	0.0000	0.0000	0.0000	0
nom-piece	0.0000	0.0000	0.0000	4
non	0.9783	0.9783	0.9783	138
not#waterproof	0.0000	0.0000	0.0000	4
numero-referance	0.0000	0.0000	0.0000	0
obtus#nixe	0.0000	0.0000	0.0000	1
olivier#cadiot	0.0000	0.0000	0.0000	1
opposition	0.0000	0.0000	0.0000	0
oui	0.9708	0.9366	0.9534	142
p	0.0000	0.0000	0.0000	0
paiement-montant-entier	0.3750	0.3000	0.3333	10
pascal	0.0000	0.0000	0.0000	0
pascal#dusapin	0.0000	0.0000	0.0000	1

pascompris	0.0000	0.0000	0.0000	0
philippe#menard	0.0000	0.0000	0.0000	2
philippe#mentrape	0.0000	0.0000	0.0000	0
piece	0.1250	0.0556	0.0769	18
piece-nom-auteur	0.0000	0.0000	0.0000	4
piece-resume	0.0000	0.0000	0.0000	1
pleintarif	0.6667	0.5714	0.6154	7
premier	0.0000	0.0000	0.0000	4
repetition-demande	0.7500	0.6000	0.6667	5
reservation	0.9621	0.9407	0.9513	135
restriction	1.0000	0.5000	0.6667	2
rien	1.0000	1.0000	1.0000	9
rouge	0.0000	0.0000	0.0000	0
samedi	0.0000	0.0000	0.0000	1
sasha#rau	0.0000	0.0000	0.0000	1
schutz#vor#der#zukunft	0.0000	0.0000	0.0000	1
sing	0.0000	0.0000	0.0000	0
singulier	0.3077	0.2105	0.2500	19
sujets#a#vif#progragraphe	0.0000	0.0000	0.0000	0
sujets#a#vif#programmation#a#dera#enedie#der#un#ange#lemoine	0.0000	0.0000	0.0000	0
sujets#a#vif#programmation#a#feure#perne#tenir	0.0000	0.0000	0.0000	0
sujets#a#vif#programmation#b#black#monde	0.0000	0.0000	0.0000	2
sujets#a#vif#programmation#d#en#ain#puy#pentanne	0.0000	0.0000	0.0000	0
sujets#a#vif#programme#a	0.0000	0.0000	0.0000	1
superieur	0.0000	0.0000	0.0000	1
susan#sontag	0.0000	0.0000	0.0000	1
tarifr	0.0000	0.0000	0.0000	0
tarifredu	0.0000	0.0000	0.0000	0
tarifreduit	0.5556	0.3125	0.4000	16
temps-date	0.4286	0.3750	0.4000	8
temps-heure	0.0000	0.0000	0.0000	1
theatre#des#idees	0.0000	0.0000	0.0000	1
troisieme	0.0000	0.0000	0.0000	1
type-public	0.0000	0.0000	0.0000	2
avg / total	0.5538	0.5273	0.5322	1007

Métriques pondérées

Slot-value Accuracy	0.1484
Slot-value Accuracy	per category
	0.0211
temps-date	0.3750
2	0.1000
sujets#a#vif#programmation#b#black#monde	0.0000
27/07	0.0000
annulation	0.5000
pascal#dusapin	0.0000
09h00	0.0000
15h00	0.0000
christoph#marthaler	0.0000
08/07	0.2500
frank#van#laecke	0.0000
not#waterproof	0.0000
france#culture#en#public	0.4000
gertrude#stein	0.0000
susan#sontag	0.0000
singulier	0.2105
3	0.1429
micro	0.0000
25/07	0.0000
22h00	0.4000
deuxieme	0.0000
miroirs#du#reel	0.0000
tarifreduit	0.3125
1	0.3684
110550	0.0000

julie#andree#t	0.3333
15/07	1.0000
nom-piece	0.0000
baal	0.0000
joelle#gayot	0.0000
comment#ai#je#pu#tenir	0.0000
info-salle	0.5000
philippe#menard	0.0000
jesaispas	0.0000
info-acces-salle	0.0000
troisieme	0.0000
nicolas#truong	0.0000
10/07	0.0000
8	0.0000
19/07	0.3333
frederic#boyer	0.0000
info-placement	0.0000
samedi	0.0000
concert	0.0000
non	0.9783
rien	1.0000
la#vingt#cinquieme#heure#dors#toi	0.0000
ludovic#lagarde	0.0000
23h00	0.2500
mathieu#bertholet	0.0000
24/07	0.0000
piece-resume	0.0000
gardenia	0.0000
16	0.0000
13	0.0000
addition	0.1538
la#vingt#cinquieme#heure#un#mage#en#ete	0.0000
repetition-demande	0.6000
information	0.9655
catherine#marnas	0.0000
premier	0.0000
7	0.0000
info-acteur	0.0000
27	0.0000
07/07	0.0000
la#mort#d'#adam	0.2500
obtus#nixe	0.0000
anna#viebrock	0.0000
euro	0.0714
restriction	0.5000
18/07	0.0000
temps-heure	0.0000
6	0.0000
12/07	1.0000
explique	0.0000
23/07	0.5000
type-public	0.0000
nb-billets	0.3333
21/07	0.0000
evenement	0.0000
26/07	0.0000
sasha#rau	0.0000
piece	0.0556
superieur	0.0000
oui	0.9366
info-acces-mobred	0.0000
theatre#des#idees	0.0000
2010	0.8235
confirmation-demande	0.0000
14/07	0.0000
chouf#ouchouf	0.0000
pleintarif	0.5714
entreelibre	0.0000

C.5. APPRIS ET TESTÉ SUR PORTMEDIA SANS INTENTION: MODE CARACTÈRES 73

```

17h00 0.5000
ecoles#au#festival 0.0000
la#tragedie#du#roi#richard#deux 0.0000
schutz#vor#der#zukunft 0.0000
18h00 0.5000
reservation 0.9407
implique 0.0000
l'#homme#sans#qualites 0.0000
4 0.0833
chloe#mons 0.0000
sujets#a#vif#programme#a 0.0000
0 0.0000
modification 0.7273
16/07 0.0000
38 0.0000
16h30 0.0000
info-auteur 0.0000
20/07 0.5000
20h00 0.0000
chapelle#des#penitents#blancs 0.0000
13/07 0.0000
la#vingt#cinquieme#heure 0.5000
lectures#d'#ecrivains 0.0000
guy#cassiers 0.0000
confirmation-annonce 0.8571
piece-nom-auteur 0.0000
boris#charmatz 0.0000
etat-piece-complet 0.0000
paiement-montant-entier 0.3000
17/07 0.0000
33 0.0000
olivier#cadiot 0.0000
jean#lambert#wild 0.0000
ecole#d'#art 0.0000
alain#platel 0.0000

```

Slot-value prec/recall/f1

	precision	recall	f1-score	support
	0.0003	0.0211	0.0006	0.012641
0	0.0000	0.0000	0.0000	0.012641
07/07	0.0000	0.0000	0.0000	0.012641
08/07	0.4235	0.2500	0.3144	0.012641
09h00	0.0000	0.0000	0.0000	0.012641
1	0.6041	0.3684	0.4577	0.012641
10/07	0.0000	0.0000	0.0000	0.012641
1010	0.0000	0.0000	0.0000	0.0
11/07	0.0000	0.0000	0.0000	0.0
110550	0.0000	0.0000	0.0000	0.012641
11h00	0.0000	0.0000	0.0000	0.0
12/07	0.5000	1.0000	0.6667	0.012641
13	0.0000	0.0000	0.0000	0.012641
13/07	0.0000	0.0000	0.0000	0.012641
14/07	0.0000	0.0000	0.0000	0.012641
15/07	0.8333	1.0000	0.9091	0.012641
15h00	0.0000	0.0000	0.0000	0.012641
16	0.0000	0.0000	0.0000	0.012641
16/07	0.0000	0.0000	0.0000	0.012641
16h30	0.0000	0.0000	0.0000	0.012641
17	0.0000	0.0000	0.0000	0.0
17/07	0.0000	0.0000	0.0000	0.012641
17h00	1.0000	0.5000	0.6667	0.012641
18/07	0.0000	0.0000	0.0000	0.012641
18h00	0.6605	0.5000	0.5691	0.012641
19/07	0.4762	0.3333	0.3922	0.012641
2	0.0964	0.1000	0.0981	0.012641
20	0.0000	0.0000	0.0000	0.0
20/07	0.5000	0.5000	0.5000	0.012641

ANNEXE C. RÉSULTATS DE L'ÉVALUATION POUR TF-SEQ2SEQ

2010	0.9669	0.8235	0.8895	0.012641
20h00	0.0000	0.0000	0.0000	0.012641
21	0.0000	0.0000	0.0000	0.0
21/07	0.0000	0.0000	0.0000	0.012641
21h00	0.0000	0.0000	0.0000	0.0
22/07	0.0000	0.0000	0.0000	0.0
22h00	0.2843	0.4000	0.3324	0.012641
23/07	0.5413	0.5000	0.5198	0.012641
23h00	1.0000	0.2500	0.4000	0.012641
24/07	0.0000	0.0000	0.0000	0.012641
25/07	0.0000	0.0000	0.0000	0.012641
26/07	0.0000	0.0000	0.0000	0.012641
27	0.0000	0.0000	0.0000	0.012641
27/07	0.0000	0.0000	0.0000	0.012641
3	0.2013	0.1429	0.1671	0.012641
33	0.0000	0.0000	0.0000	0.012641
38	0.0000	0.0000	0.0000	0.012641
4	0.2121	0.0833	0.1197	0.012641
5	0.0000	0.0000	0.0000	0.0
6	0.0000	0.0000	0.0000	0.012641
7	0.0000	0.0000	0.0000	0.012641
8	0.0000	0.0000	0.0000	0.012641
addition	0.9161	0.1538	0.2635	0.012641
alain#platel	0.0000	0.0000	0.0000	0.012641
anna#viebrock	0.0000	0.0000	0.0000	0.012641
annulation	0.7258	0.5000	0.5921	0.012641
antoinat	0.0000	0.0000	0.0000	0.0
baal	0.0000	0.0000	0.0000	0.012641
bal#du#beran	0.0000	0.0000	0.0000	0.0
boris#charmatz	0.0000	0.0000	0.0000	0.012641
catherine#marnas	0.0000	0.0000	0.0000	0.012641
chapelle#des#penitents#blancs	0.0000	0.0000	0.0000	0.012641
checres#adine	0.0000	0.0000	0.0000	0.0
chloe#mons	0.0000	0.0000	0.0000	0.012641
chlottre#mar	0.0000	0.0000	0.0000	0.0
chouf#ouchouf	0.0000	0.0000	0.0000	0.012641
christoph#marthaler	0.0000	0.0000	0.0000	0.012641
comment#ai#je#pu#tenir	0.0000	0.0000	0.0000	0.012641
concert	0.0000	0.0000	0.0000	0.012641
confirmation-annonce	0.6219	0.8571	0.7208	0.012641
confirmation-demande	0.0000	0.0000	0.0000	0.012641
deuxieme	0.0000	0.0000	0.0000	0.012641
ecole#d'#art	0.0000	0.0000	0.0000	0.012641
ecoles#au#festival	0.0000	0.0000	0.0000	0.012641
entreelibre	0.0000	0.0000	0.0000	0.012641
etat-piece-complet	0.0000	0.0000	0.0000	0.012641
euro	0.9103	0.0714	0.1325	0.012641
evenement	0.0000	0.0000	0.0000	0.012641
expli	0.0000	0.0000	0.0000	0.0
explique	0.0000	0.0000	0.0000	0.012641
fhliviengarel	0.0000	0.0000	0.0000	0.0
fhris#truogragel	0.0000	0.0000	0.0000	0.0
flip#book	0.0000	0.0000	0.0000	0.0
france#culture#en#public	0.1373	0.4000	0.2044	0.012641
frank#van#laecke	0.0000	0.0000	0.0000	0.012641
franxack	0.0000	0.0000	0.0000	0.0
frederic#boyer	0.0000	0.0000	0.0000	0.012641
gardenia	0.0000	0.0000	0.0000	0.012641
gertrude#stein	0.0000	0.0000	0.0000	0.012641
guy#cassiers	0.0000	0.0000	0.0000	0.012641
impli	0.0000	0.0000	0.0000	0.0
implique	0.0000	0.0000	0.0000	0.012641
info-acces-mobred	0.0000	0.0000	0.0000	0.012641
info-acces-salle	0.0000	0.0000	0.0000	0.012641
info-acteur	0.0000	0.0000	0.0000	0.012641
info-auteur	0.0000	0.0000	0.0000	0.012641
info-placement	0.0000	0.0000	0.0000	0.012641
info-salle	0.2000	0.5000	0.2857	0.012641

C.5. APPRIS ET TESTÉ SUR PORTMEDIA SANS INTENTION: MODE CARACTÈRES 75

information	0.9507	0.9655	0.9581	0.012641
jean	0.0000	0.0000	0.0000	0.0
jean#lamber#tion	0.0000	0.0000	0.0000	0.0
jean#lambert#wild	0.0000	0.0000	0.0000	0.012641
jean#rietopoer	0.0000	0.0000	0.0000	0.0
jesaispas	0.0000	0.0000	0.0000	0.012641
joelle#gayot	0.0000	0.0000	0.0000	0.012641
julie	0.0000	0.0000	0.0000	0.0
julie#andree#t	1.0000	0.3333	0.5000	0.012641
l'#afconge#robenta	0.0000	0.0000	0.0000	0.0
l'#homme#sans#qualites	0.0000	0.0000	0.0000	0.012641
l'#orchestre#perdu	0.0000	0.0000	0.0000	0.0
la#contre#soux	0.0000	0.0000	0.0000	0.0
la#contre#sesuse#tesine	0.0000	0.0000	0.0000	0.0
la#mort#d'#adam	1.0000	0.2500	0.4000	0.012641
la#tragedie#du#roi#richard#deux	0.0000	0.0000	0.0000	0.012641
la#vingt#cinquiem	0.0000	0.0000	0.0000	0.0
la#vingt#cinquieme#heure	0.9595	0.5000	0.6574	0.012641
la#vingt#cinquieme#heure#derzer	0.0000	0.0000	0.0000	0.0
la#vingt#cinquieme#heure#deure	0.0000	0.0000	0.0000	0.0
la#vingt#cinquieme#heure#dors#toi	0.0000	0.0000	0.0000	0.012641
la#vingt#cinquieme#heure#echif#	0.0000	0.0000	0.0000	0.0
la#vingt#cinquieme#heure#en#atere#entaer	0.0000	0.0000	0.0000	0.0
la#vingt#cinquieme#heure#en#emen#eine	0.0000	0.0000	0.0000	0.0
la#vingt#cinquieme#heure#en#en#en#ete	0.0000	0.0000	0.0000	0.0
la#vingt#cinquieme#heure#en#pub	0.0000	0.0000	0.0000	0.0
la#vingt#cinquieme#heure#en#public	0.0000	0.0000	0.0000	0.0
la#vingt#cinquieme#heure#un#mage#en#ete	0.0000	0.0000	0.0000	0.012641
lectures#d'#ecrivains	0.0000	0.0000	0.0000	0.012641
ludovic#lagarde	0.0000	0.0000	0.0000	0.012641
mathieu#bertholet	0.0000	0.0000	0.0000	0.012641
micro	0.0000	0.0000	0.0000	0.012641
miroirs#du#reel	0.0000	0.0000	0.0000	0.012641
modification	0.9627	0.7273	0.8286	0.012641
nb-billets	0.9595	0.3333	0.4948	0.012641
nicolas#truong	0.0000	0.0000	0.0000	0.012641
nom-liec	0.0000	0.0000	0.0000	0.0
nom-piece	0.0000	0.0000	0.0000	0.012641
non	0.9789	0.9783	0.9786	0.012641
not#waterproof	0.0000	0.0000	0.0000	0.012641
numero-referance	0.0000	0.0000	0.0000	0.0
obtus#nixe	0.0000	0.0000	0.0000	0.012641
olivier#cadiot	0.0000	0.0000	0.0000	0.012641
opposition	0.0000	0.0000	0.0000	0.0
oui	0.7253	0.9366	0.8176	0.012641
p	0.0000	0.0000	0.0000	0.0
paiement-montant-entier	0.5189	0.3000	0.3802	0.012641
pascal	0.0000	0.0000	0.0000	0.0
pascal#dusapin	0.0000	0.0000	0.0000	0.012641
pascompris	0.0000	0.0000	0.0000	0.0
philippe#menard	0.0000	0.0000	0.0000	0.012641
philippe#mentrape	0.0000	0.0000	0.0000	0.0
piece	0.1597	0.0556	0.0824	0.012641
piece-nom-auteur	0.0000	0.0000	0.0000	0.012641
piece-resume	0.0000	0.0000	0.0000	0.012641
pleintarif	0.8915	0.5714	0.6965	0.012641
premier	0.0000	0.0000	0.0000	0.012641
repetition-demande	0.9884	0.6000	0.7467	0.012641
reservation	0.9639	0.9407	0.9522	0.012641
restriction	1.0000	0.5000	0.6667	0.012641
rien	1.0000	1.0000	1.0000	0.012641
rouge	0.0000	0.0000	0.0000	0.0
samedi	0.0000	0.0000	0.0000	0.012641
sasha#rau	0.0000	0.0000	0.0000	0.012641
schutz#vor#der#zukunft	0.0000	0.0000	0.0000	0.012641
sing	0.0000	0.0000	0.0000	0.0
singulier	0.7686	0.2105	0.3305	0.012641
sujets#a#vif#progragrapge	0.0000	0.0000	0.0000	0.0

sujets#a#vif#programmation#a#dera#enedie#der#un#ange#lemoine	0.0000	0.0000	0.0000	0.0
sujets#a#vif#programmation#a#feure#perne#tenir	0.0000	0.0000	0.0000	0.0
sujets#a#vif#programmation#b#black#monde	0.0000	0.0000	0.0000	0.012641
sujets#a#vif#programmation#d#en#ain#puy#pentanne	0.0000	0.0000	0.0000	0.0
sujets#a#vif#programme#a	0.0000	0.0000	0.0000	0.012641
superieur	0.0000	0.0000	0.0000	0.012641
susan#sontag	0.0000	0.0000	0.0000	0.012641
tarifr	0.0000	0.0000	0.0000	0.0
tarifredu	0.0000	0.0000	0.0000	0.0
tarifreduit	0.6558	0.3125	0.4233	0.012641
temps-date	0.1759	0.3750	0.2395	0.012641
temps-heure	0.0000	0.0000	0.0000	0.012641
theatre#des#idees	0.0000	0.0000	0.0000	0.012641
troisieme	0.0000	0.0000	0.0000	0.012641
type-public	0.0000	0.0000	0.0000	0.012641
avg / total	0.2052	0.1484	0.1578	1.630763

Annexe D

La distribution des slot-values dans le corpus utilisé par Tf-seq2seq

Le tableau [D.1](#) montre la distribution des slot-values par chaque slot-label dans Train (Artificiel, SWEET-HOME) et Test (VocADom) utilisés pour apprendre et tester le modèle Tf-seq2seq. La distribution est représenté comme une proportion : le nombre d'occurrence d'un slot-value donné dans Train divisé par son nombre d'occurrence dans Test.

Slot-labels										
action	device	location-room	location-floor	location-house	location-relative	location-in-room	device-component	device-setting	room-property	value-numeric
turn_up 7811/48	window 630/90	bedroom 6912/290	0 10870/253	house 0/1	middle 0/1	ceiling 0/13	volume 4200/2	opened 33/85	temperature 87/17	2 0/1
raise 1218/83	light 11387/232	living_room 7968/25	1 10870/273		right 0/1	night_table 0/7	channel 1050/3	on 0/26		
change 1050/3	blind 3690/642	study 4800/81				stairs 0/2		closed 0/60		
turn_down 3350/53	fan 250/70	ceiling 0/1						off 0/13		
turn_off 3758/359	heating 0/18	wc 3000/75								
lower 1239/207	shower 0/2	bathroom 3613/83								
turn_on 3757/152	radio 29/148	kitchen 4219/115								
stop 100/131	curtain 4/157									
open 3928/202	kettle 50/67									
close 3911/224	tv_music_player 3000/92									
	shutter 1202/59									
	door 3002/47									

FIGURE D.1 – La distribution des slot-values par chaque slot-label pour le corpus utilisé pour Tf-seq2seq